

DUAL SPORTS

2023

v2323 0110

■ ABOUT US

A CROSSPRO, fundada em 2005, é uma empresa que se dedica ao fabrico de proteções e acessórios para o segmento de veículos de 2 e 4 rodas.

A paixão pela modalidade, a noção das exigências pela prática do desporto e o bom conhecimento de mecânica dos seus fundadores posicionaram a CROSSPRO neste segmento de mercado, marca que rapidamente ganha na Europa reconhecimento e reputação, fruto do trabalho e especial cuidado com a qualidade obtida na produção e desenvolvimento dos seus produtos. A constante procura por novas e inovadoras soluções permitiram expandir para outros mercados e atualmente assegurar a presença da marca a nível mundial.

Todo o processo produtivo é feito na unidade fabril com sede em Portugal e com recurso a mão de obra especializada, matéria prima da mais alta qualidade e tecnologia de ponta.

CROSSPRO, founded in 2005, is a company dedicated to the manufacture of protections and accessories for the 2 and 4 wheel vehicle segment.

The passion for motorized sport and the notion of its demands, through the practice of this sport, combined with the good mechanical knowledge of its founders, positioned CROSSPRO in this market segment. A brand that quickly gains recognition and reputation in Europe, the result of hard work and the special care taken with the quality obtained in the production and development of its products.

The constant search for new and innovative solutions made it possible to expand to other markets and currently ensure the brand's presence worldwide.

The entire production process is carried out in the factory located in

Portugal, using specialized labor, the highest quality raw materials and cutting-edge technology.

■ ABOUT OUR PRODUCTS

Os nossos produtos são submetidos a um rigoroso controlo de qualidade e testados em condições extremas, sendo adequados desde o utilizador convencional até ao utilizador profissional de alta competição. Garantem, portanto, uma máxima performance.

A aposta numa melhoria contínua, quer seja pela exigência das novas tendências de mercado, quer pelas necessidades dos nossos clientes, é um fator que nos distingue.

Temos como preocupação as necessidades dos nossos clientes, estando sempre atentos ao seu *feedback*, procurando antecipar e ajustar a nossa gama de produtos.

A mudança de instalações em 2017, agora com 5000m2 de área coberta, aliada a um forte investimento estratégico em nova maquinaria, tais como corte a laser, célula de solda robotizada, máquina de lixar por planos, unidade de pintura eletrostática, máquina de dobrar tubo CNC, entre outras, bem como o *know-how* adquirido, projetou a entrada da CROSSPRO para novas áreas de negócio, com novas parcerias e novos desafios, alargando as suas valências no sector metalomecânico para variados tipos de produtos.

Our products are subjected to strict quality control and tested under extreme conditions, being suitable from the conventional user to the professional user of high competition. Therefore, they guarantee maximum performance.

The commitment to continuous improvement, whether due to the demands of new market trends or the needs of our customers, is a factor that distinguishes us.

Our main concern is the customer's needs, we are always in communication and attentive to their feedback, seeking to anticipate and adjust our product range.

The change of facilities in 2017, now with 5000m2 of covered area, combined with a strong strategic investment in new machinery, such as a laser cutting unit, robotic welding cell unit, flat sanding machine, electrostatic painting unit, CNC tube bending, among others, as well as the team's know-how, projected CROSSPRO's entry into new business areas, with new partnerships and new challenges, expanding its valences in the metalworking sector to various types of products.

CROSSPRO is, for all these reasons, synonymous of Quality and Reliability.

CROSSPRO é sinónimo de qualidade e fiabilidade.



Management System
ISO 9001:2015



www.tuv.com
ID 910507726

A CROSSPRO, sempre atenta às tendências, acompanha o crescimento do segmento Dual Sports e desenvolve Proteções de Carenagem completas e Proteções de Motor, duas das zonas mais críticas da moto a ter em conta. São produzidas em alumínio, matéria prima de alta resistência que marcam diferença face às fabricadas pela concorrência e oferecem vantagens como:

- Peso reduzido, maior leveza logo menos consumo e uma maior performance;
- Não oxida, mantém a cor e prolonga o aspeto de novo;
- Menos desgaste da moto ao proteger zonas sensíveis;
- Personalização, com oferta de um leque variado de cores disponíveis para ir de encontro ao gosto do cliente;
- O alumínio atende à sensibilidade para as questões ambientais por ser uma matéria-prima reutilizável.

Além das proteções referidas, a CROSSPRO desenvolveu uma linha de acessórios que combinam o alumínio com o aço inoxidável, para zonas mais expostas e sensíveis da moto, com um design simples e inovador, sempre com a preocupação de garantir uma máxima proteção.

CROSSPRO, always focused on market trends, observes the growth of the Dual Sports segment and has developed, among others, full fairing protections and engine protections, two of the most critical areas of the bike to take into account. They are produced in aluminium, a high-resistance raw material, they make a difference compared to those manufactured by the competition and offer advantages such as:

- Reduced weight, greater lightness, therefore less consumption and greater performance;
- Does not oxidize, keeps its color and appearance as new;
- Less motorcycle wear by protecting sensitive areas;
- Personalization, offering a wide range of colors available, meeting the customer's taste;
- Aluminium itself, which meets sensitivity to environmental concerns as it is a reusable, recyclable raw material.

In addition to the aforementioned protections, CROSSPRO has developed and has available a line of accessories that combine aluminum with stainless steel, for other more exposed and sensitive areas of the motorcycle, with a simple and innovative design, always with the aim of guaranteeing maximum protection.

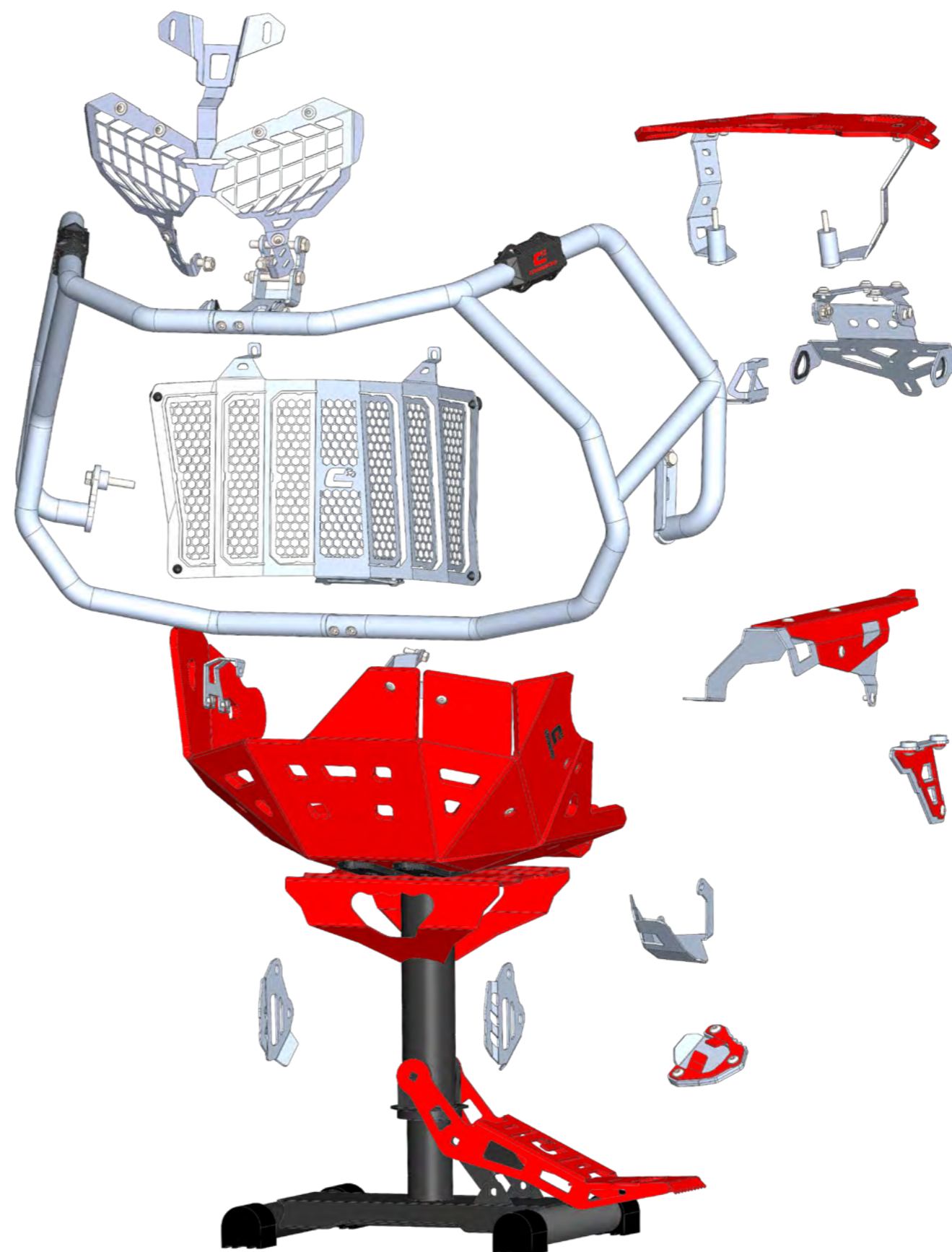

EQUIP

YOUR

DREAM

MOTORCYCLE

WITH

CROSSPRO

PRODUCTS

- 12 - *AJP*
- 14 - *APRILIA* ■ **NEW**
- 16 - *BENELLI*
- 22 - *BMW*
- 64 - *DUCATI* ■ **NEW**
- 68 - *HONDA*
- 98 - *HUSQVARNA*
- 102 - *KAWASAKI*
- 108 - *KTM*
- 132 - *MOTO-MORINI*
- 136 - *SUZUKI*
- 156 - *TRIUMPH*
- 162 - *YAMAHA*



10

■ **CONTENT** ■
table of

PRODUCT CATEGORY

08

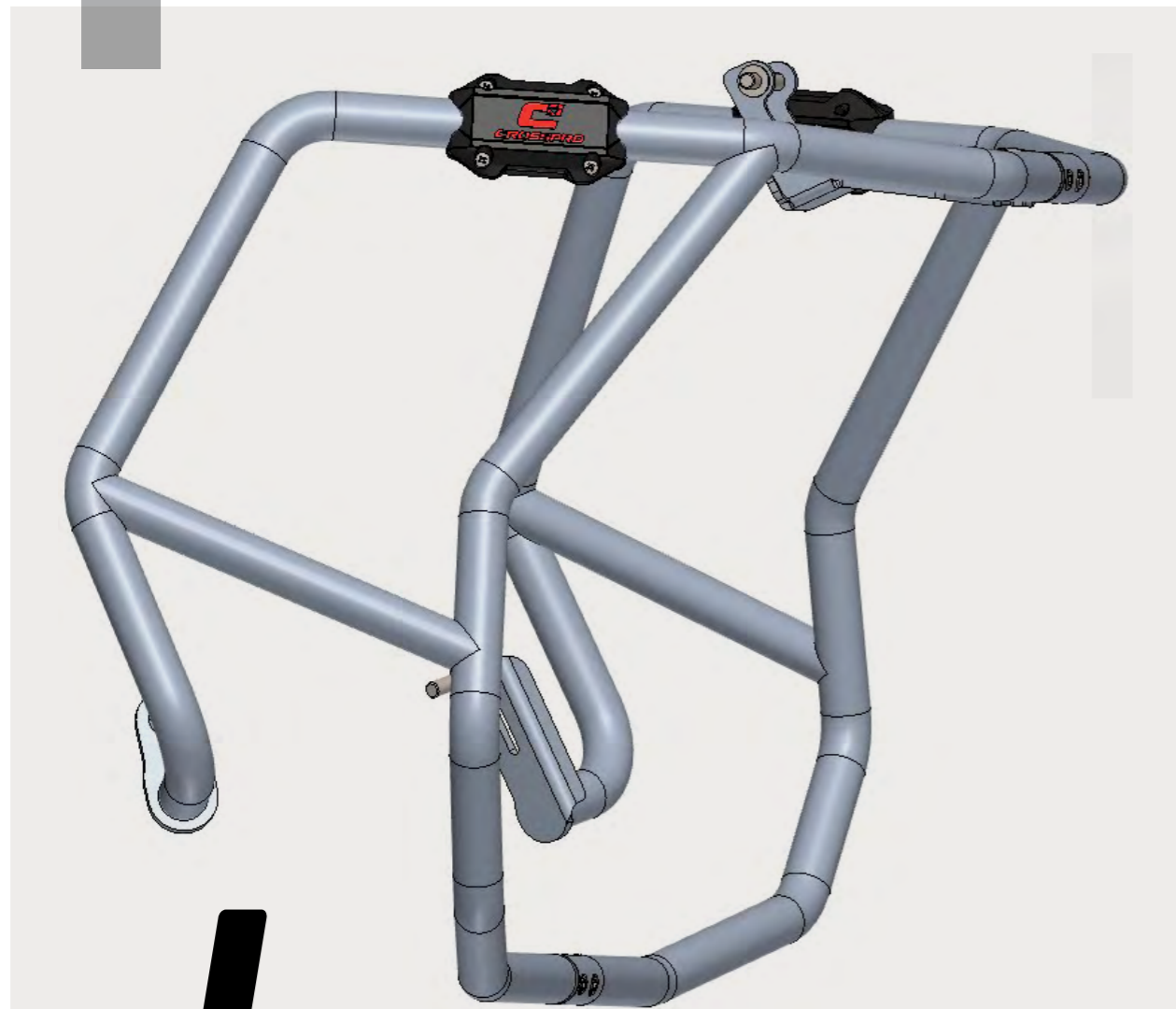

**THE
BEST
SALES**

2CP197 Aluminum Crash Bar

- Aluminum protections
- Reduced weight
- Maximum Resistance
- Innovative Design
- Maximum protection to your bike
- Produced in high quality aluminum, with 25mm diameter and 3mm thickness

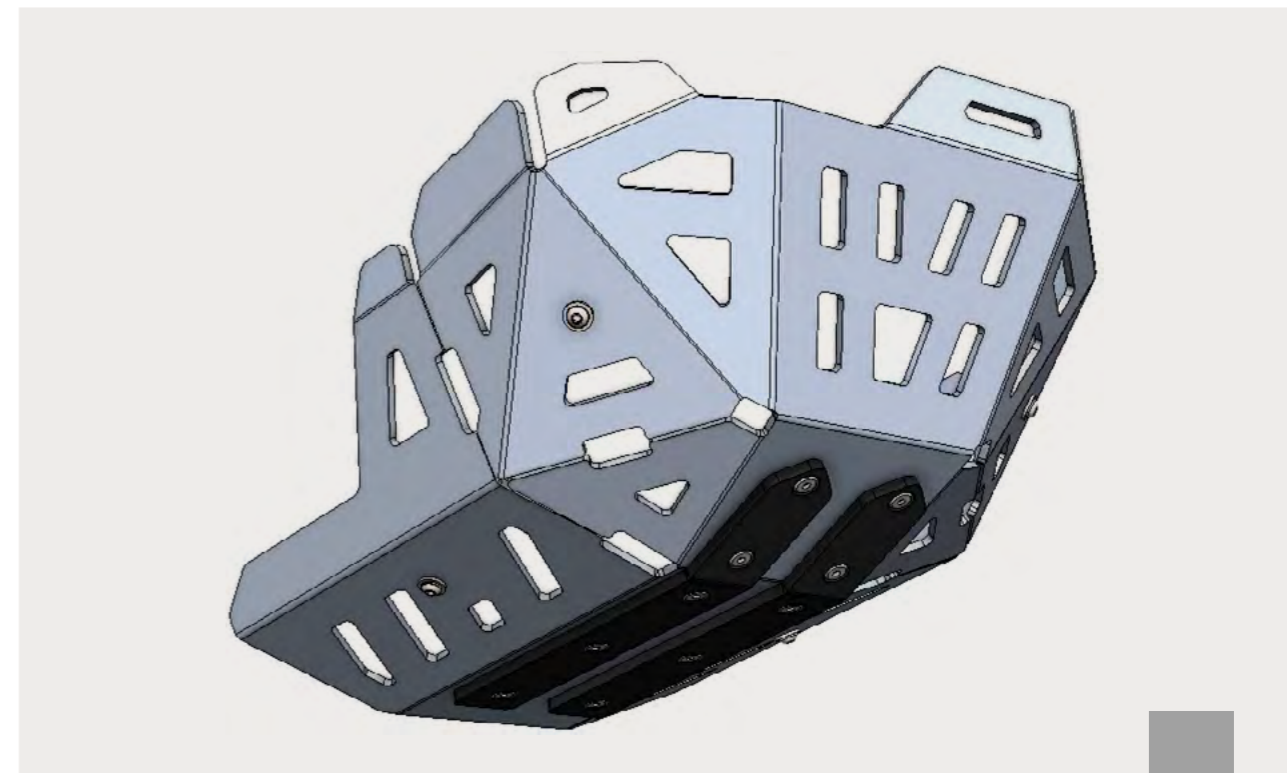

2CP090 Aluminum Engine Guard

Made of the highest quality aluminum, 4mm thickness. It protects your motorcycle's engine with maximum effectiveness against impacts and stone projections.

2CP207 License Plate Support

- Made of stainless steel
- Easy to install
- Simple maintenance
- High strength
- Available in multiple colors



2CP210 Radiator Aluminum Guard

The CrossPro radiator were specially designed to protect your Cooling System, your bike's most fragile and important component - without obstructing airflow to the radiator. Designed as a "radiator roll cage", the CrossPro radiator protection secures a perimeter around the radiator, without its fixation points are in direct contact with the radiator. With this security perimeter, hard impacts won't affect your radiator. Made by best quality aluminum, with a thickness of 3mm

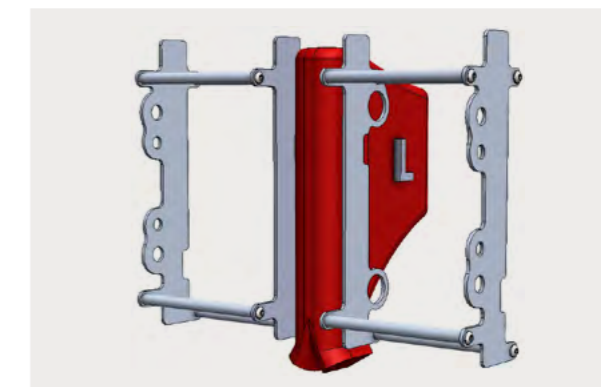

for the real **ADVENTURERS**

05. 2CP214 Chain Guard

We developed this protection in order to increase the security, it's more resistant than the original part, the chain guard combines stainless steel and aluminium yet is still relatively light
The mounting of the part is based on a "do it yourself" allowing a easy mounting and maintenance
This piece allows you to combine different colours

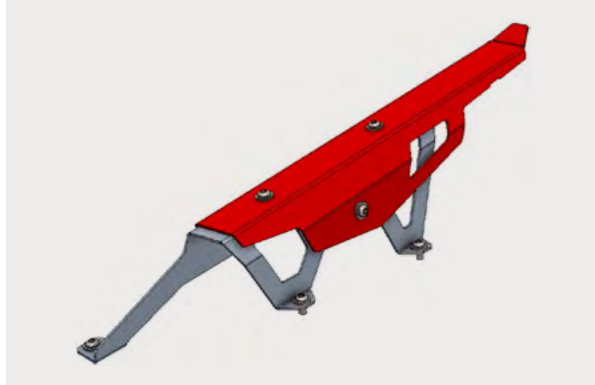

06. 2CP215 Chain Guard Fin

This lower protection it's a combination of aluminium/stainless steel, secure your chain guard preventing branches and other objects from knocking the chain of the drive sprocket.
The chain guard fin is stronger than the original plastic item!
Existing fixation points can be used, which makes this chain guard easy to mount at your home.
Available in different colours



07. 2CP216 Parking Brake Guard

Protects the parking brake against damage Made in Stainless Steel
Easy to install
Rust-proof with simple maintenance
Available in different colours

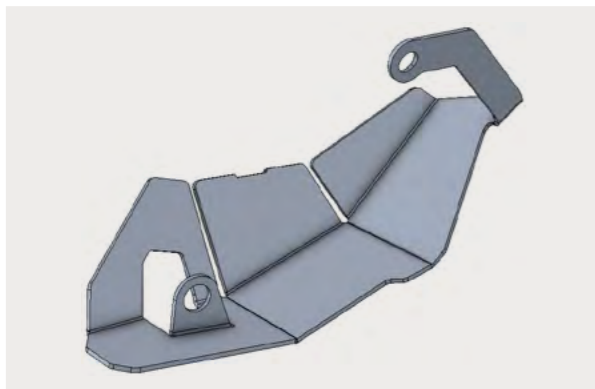

08. 2CP217 Brake Calliper Guard

Protects the callipers against damage
Made in Stainless Steel
Easy to install
Rust-proof with simple maintenance
Available in different colours

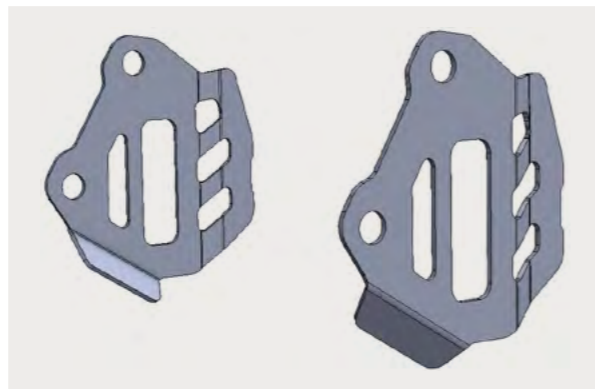

09. 2CP218 Rear Brake Fluid Reservoir Guard

Made from laser-cut stainless steel, the brake fluid reservoir guard effectively prevents damage and undesired access to the reservoir lid, yet allowing easily see the fluid level, controlling the necessary maintenance. The protection is mounted using the existing mounting point.
Available in different colours

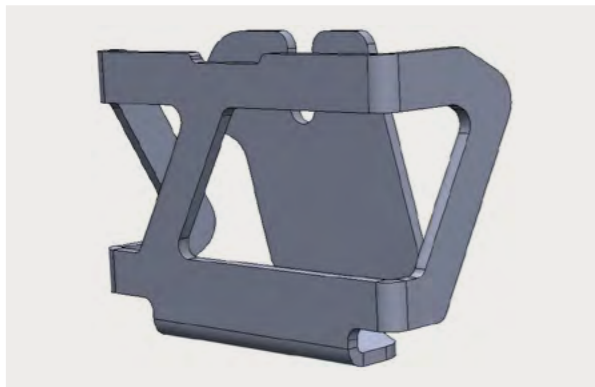

10. 2CP219 Dual Clutch Transmission (DCT)

Protects the Dual Clutch Transmission against damage
The stainless steel protection is simple to install, rust-proof with simple maintenance



PRODUCT CATEGORY

11

2CP220 Side Stand Base Extension

Combines stainless steel and aluminum increase the area of supporting the bike Gives more stability in different types of grounds when using the rest Easy to install Available in different colours

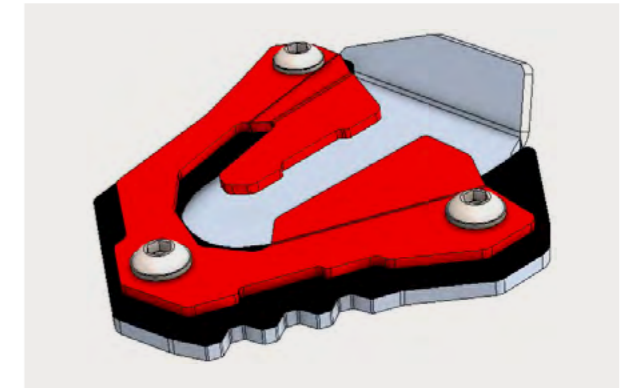

2CP222 Luggage Rack

Optimise the stowage of your luggage on your Africa Twin!
The luggage rack, made of 4mm thick aluminium, is precisely laser-machined and virually doubles the usable surface area of the original Honda luggage rack. The surface of your rack has great optics, the shape adapts elegantly to the motorbike's design. Numerous recesses and slots for straps offer a variety of lashing options. The wide design even offers large pieces of luggage a firm hold. The rack can be fitted quickly and easily.

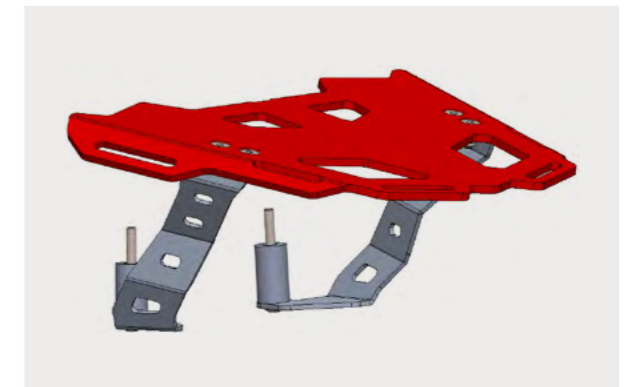

2CP221 Head Light Protector

Stainless steel headlight protector was design to maximize the protection and at the same time beautify your motorcycle
Easy to install
Available in different colours



2CP227 Radiator Guard

Protects the radiator from stones being thrown up from the ground
Laser-cut stainless steel, does not affect the radiator function
The radiator cover can cause the engine to overheat under extreme conditions with high outside temperatures and an extreme engine load



2CP124 DTC Skidplate

Tested in hostile conditions, this skidplates offer the best protection for the engine and frame of your bike in hard tracks. Produced in best quality DTC with 8mm thickness without helds, they're 40% ligh comparing with aluminum. They're more resistentes to impact and causo no vibrations. Reinforced with 6mm stripes bellow to overcome easilly obstacles.
Available in different colors (Blue, Red and Black).



for the real ADVENTURERS

■ AJP PR7 650 ADVENTURE 2017-2022



ENGINE GUARD

SKU: 2CP0900040****



CRASHBARS

SKU: 2CP197040B**** /// PART NUMBER UPDATED



RADIATOR GUARD

SKU: 2CP2100040****



for the real ADVENTURERS

NEW

APRILIA TUAREG 2022



360°



Available in various colors
See page: 191

for the real **ADVENTURERS**



3.10kg 4mm AI Aluminum

ENGINE GUARD

SKU: 2CP090031A****

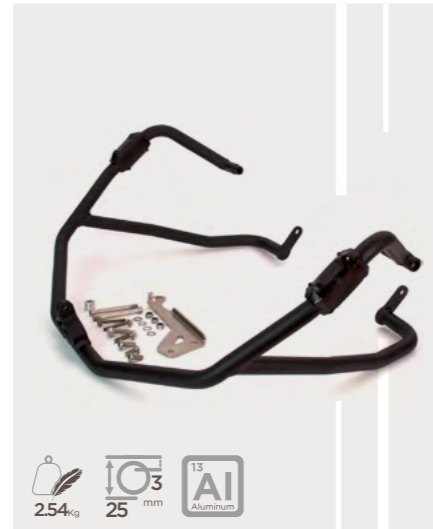

2.54kg 25mm AI Aluminum

CRASHBARS

SKU: 2CP1970031****



0.26kg 2mm 304 STAINLESS STEEL

LICENSE PLATE SUPPORT

SKU: 2CP207038A****



■ BENELLI TRK 502 2017-2020





■ BENELLI TRK 502 X 2018-2021



2.98g 4mm AI Aluminum

ENGINE GUARD

SKU: 2CP090042B****

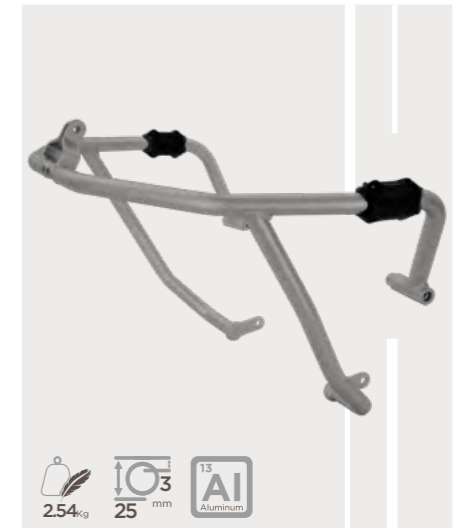

2.54g 25mm AI Aluminum

CRASHBARS

SKU: 2CP1970031****



360°



0.26g 2mm 304 STAINLESS STEEL

LICENSE PLATE SUPPORT

SKU: 2CP207038A****



@di.barradas
@estebesbb

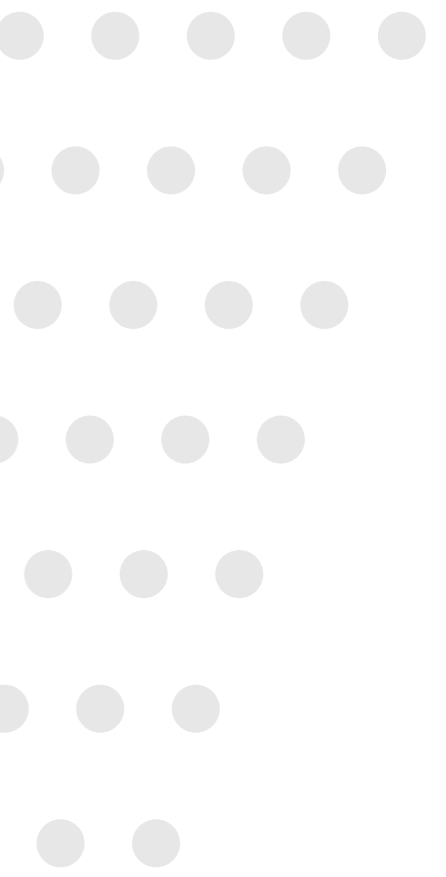
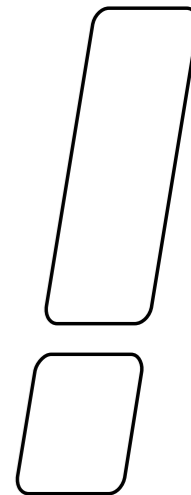

for the real **ADVENTURERS**

■ BMW R nineT all models (K33) 2016-2022

nineT URBAN



ENGINE GUARD

SKU: 2CP090043A****



CRASHBARS

SKU: 2CP1970043****





ENGINE GUARD

SKU: 2CP0900056****



CRASHBARS

SKU: 2CP1970056****

■ **BMW G310GS (K2) 2016-2020**



RADIATOR GUARD

SKU: 2CP2270056****

Available in various colors

See page: 191

for the real **ADVENTURERS**

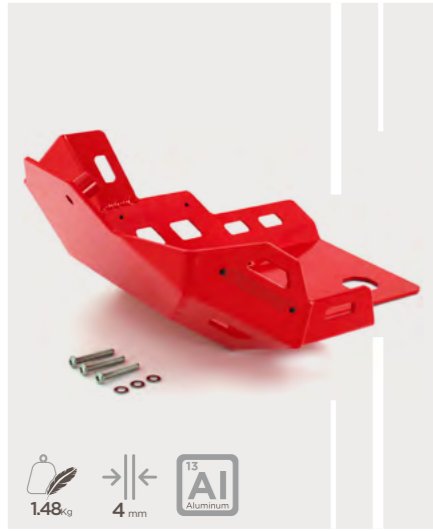

ENGINE GUARD

SKU: 2CP0900036****

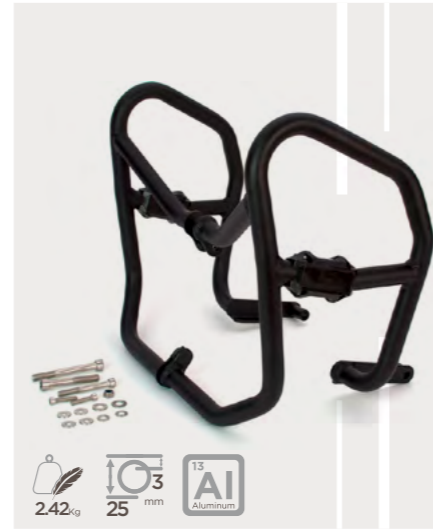

CRASHBARS

SKU: 2CP1970036****

■ BMW F650 GS (R13) 1999-2007

 Available in various colors

See page: 191



for the real **ADVENTURERS**

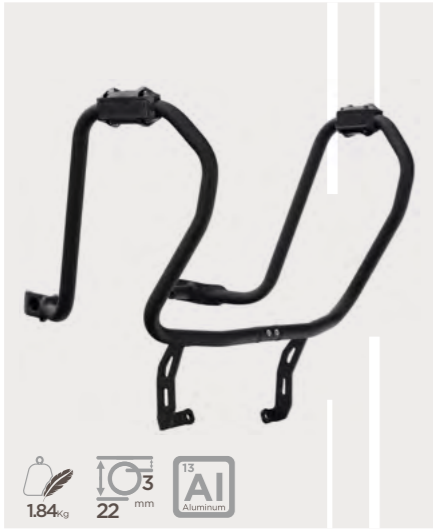

1.84kg
22 mm
Aluminum

CRASHBARS

SKU: 2CP1250005****



2.20kg
4 mm
Aluminum

ENGINE GUARD

SKU: 2CP0900005****

■ **BMW F650 GS** **(K72)** **2008-2012**

Available in various colors
See page: 191



for the real **ADVENTURERS**



ENGINE GUARD

SKU: 2CP090044A****



CRASHBARS

SKU: 2CP197044A****



■ **BMW** **F750GS (K80)** **2016-2020**





■ BMW F800GS (K72) 2007-2016

Available in
various colors

See page: 191



2.20 kg 4 mm 

ENGINE GUARD

SKU: 2CP090001****



2.24 kg 22 mm 

CRASHBARS

SKU: 2CP1250001****

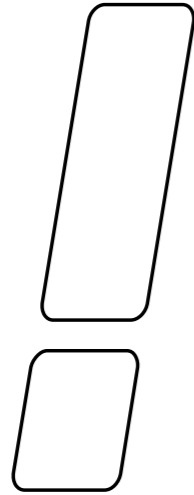

***CrossPro,
Ride it
like a PRO...***



■ BMW F 800 GS (K75) Adventure 2012-2018



2.20 kg 4 mm AI Aluminum

ENGINE GUARD

SKU: 2CP0900001****

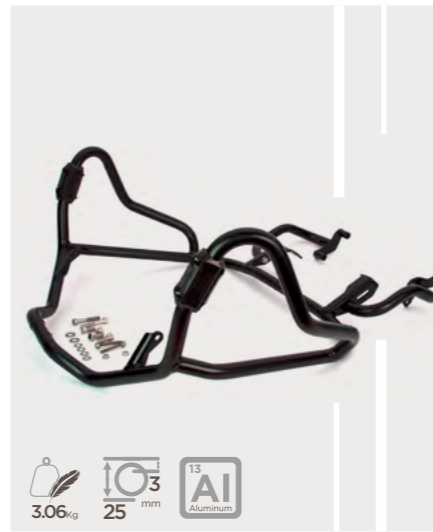

3.06 kg 25 mm AI Aluminum

CRASHBARS

SKU: 2CP1970033****



for the real **ADVENTURERS**



360°



2.80g 4 mm AI Aluminum

ENGINE GUARD

SKU: 2CP090044A****



3.70g 25 mm AI Aluminum

CRASHBARS

SKU: 2CP197044A****



■ **BMW F850GS (K81) 2016-2020**

Available in various colors
See page: 191

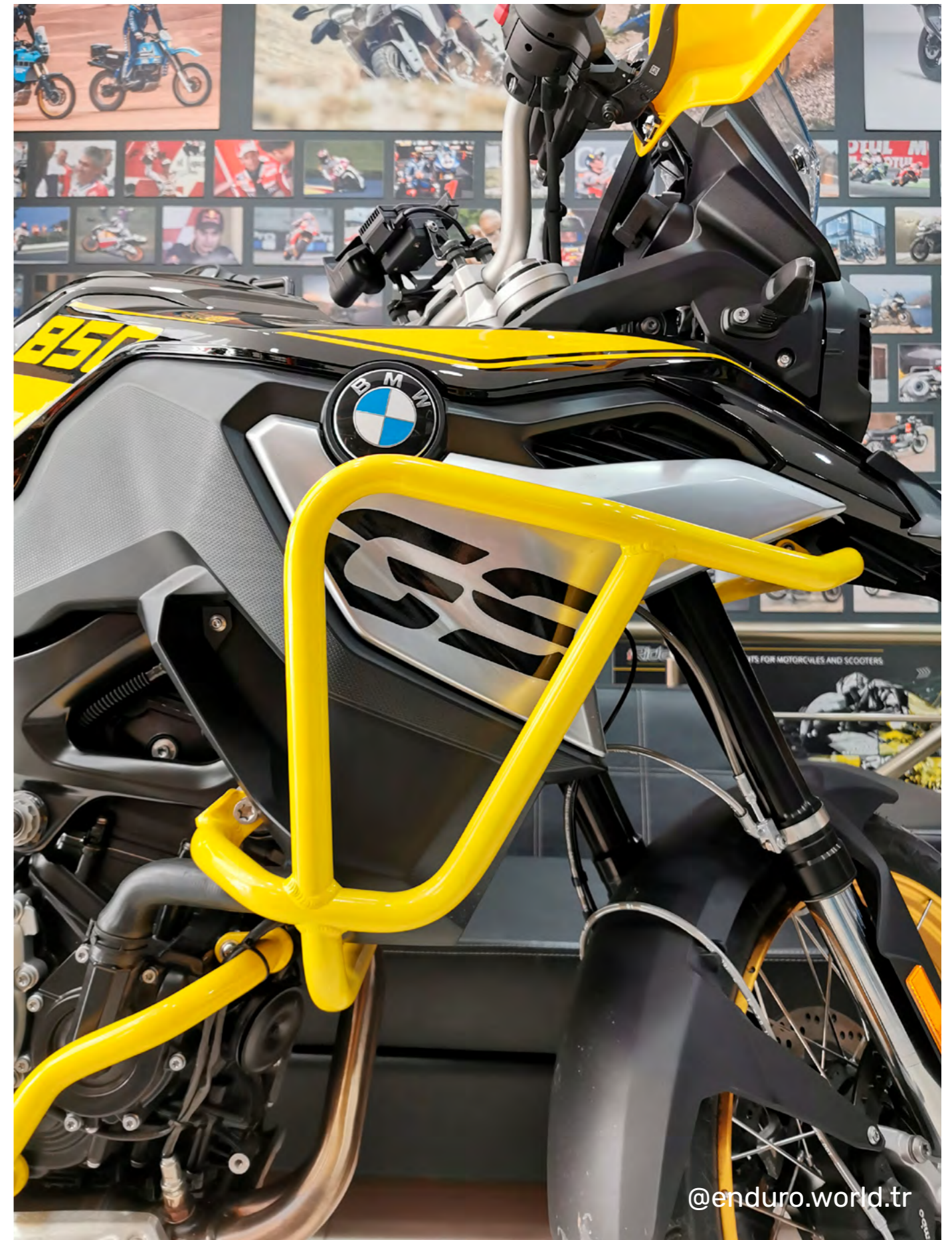

@enduro.world.tr

for the real ADVENTURERS

NEW



360°

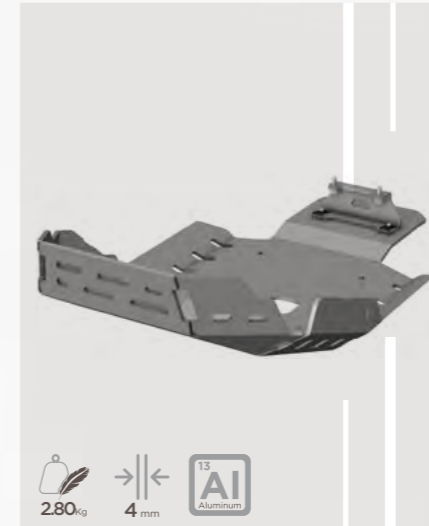

2.80kg 4 mm AI Aluminum

ENGINE GUARD
** Compatible with OEM Crash Bars*
SKU: 2CP0900080****



3.94kg 25 mm AI Aluminum

CRASHBARS
SKU: 2CP1970080****



0.18kg 2 mm 304 STAINLESS STEEL

SIDE STAND EXTENTION
SKU: 2CP2200080****



0.70kg 1.5 mm 304 STAINLESS STEEL

RADIATOR GUARD
SKU: 2CP2270080****

Available in various colors

See page: 191

■ BMW F850GS Adventure 2021-2022

■ BMW R 1150 GS (R21) 1999-2004 (R21A) 2002-2006



360°



CRASHBARS

SKU: 2CP1970045**** R1150GS Adventure
SKU: 2CP1970041**** R1150GS



ENGINE GUARD

SKU: 2CP0900041****



for the real **ADVENTURERS**

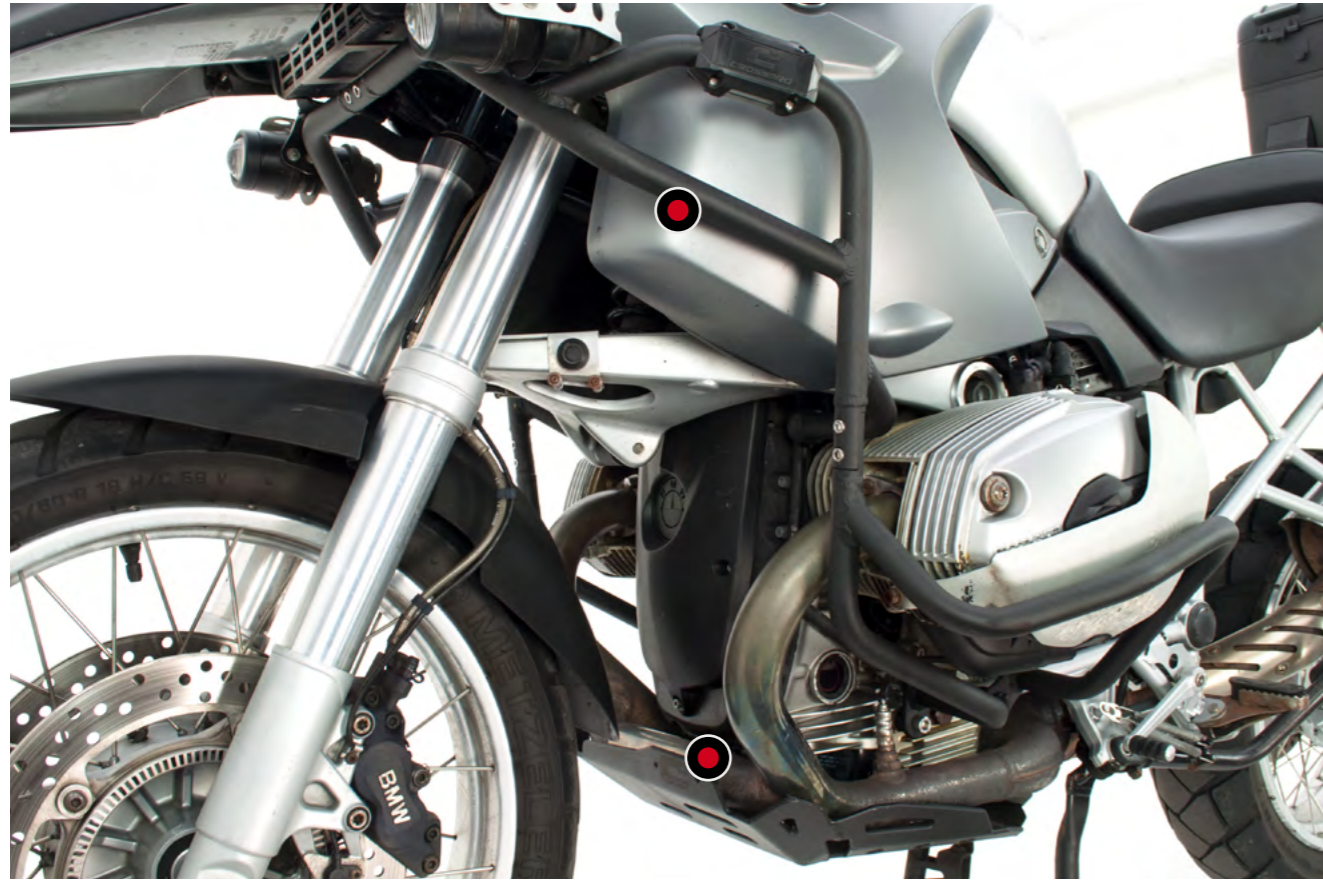

■ **BMW R1200GS (K25)** **2003-2007**



156g 4 mm 

ENGINE GUARD

SKU: 2CP090003A****



3.00g 22 mm 

CRASHBARS

SKU: 2CP125003A****

 Available in various colors

See page: 191





■ BMW R1200GS 2008-2012



1.72g 4mm AI Aluminum

ENGINE GUARD

SKU: 2CP090010A****



3.14g 22mm AI Aluminum

CRASHBARS

SKU: 2CP1250010****

Available in various colors
See page: 191



■ BMW R1200GS (K50) 2013-2016

Available in
various colors
See page: 191



1.50kg 4mm AI Aluminum

ENGINE GUARD

SKU: 2CP0900015****

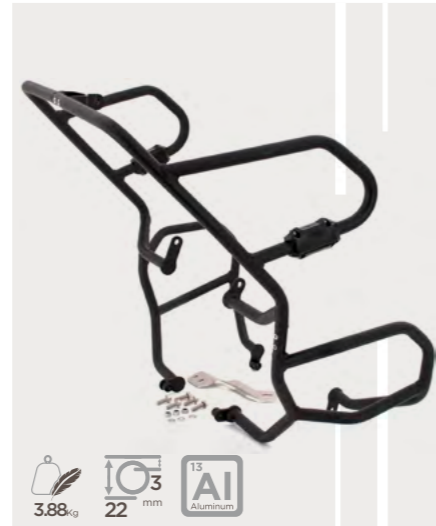

3.88kg 22mm AI Aluminum

CRASHBARS

SKU: 2CP1250015****





@di.barradas
@estevesbb

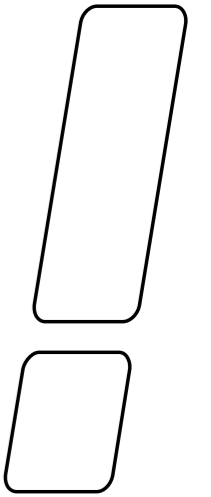



■ BMW R 1200 GS (K50) 2017

Available in various colors
See page: 191



1.50kg 4mm AI Aluminum

ENGINE GUARD

SKU: 2CP0900015****

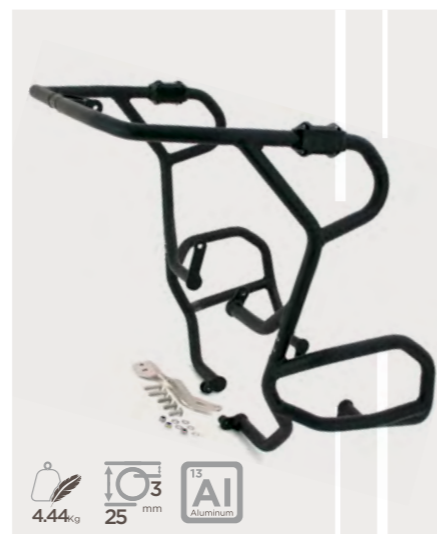

4.44kg 25mm AI Aluminum

CRASHBARS

SKU: 2CP1970030****

for the real ADVENTURERS

■ BMW R 1200 GS Adventure (K255) 2008-2013



ENGINE GUARD

SKU: 2CP090010A****



CRASHBARS

SKU: 2008-2009 2CP1970069****
SKU: 2010-2013 2CP1970037****



Available in various colors
See page: 191

■ BMW R1200GS Adventure (K51) 2014-2018



ENGINE GUARD

SKU: 2CP0900015****



CRASHBARS

SKU: 2CP1970035****



BMW GS R 1250

■ **BMW R 1250 GS (K50) 2019**



1.50kg 4mm ¹³AI Aluminum

ENGINE GUARD

SKU: 2CP0900050****



4.66kg 25mm ¹³AI Aluminum

CRASHBARS

SKU: 2CP1970050****



Available in various colors

See page: 191





■ **BMW R 1250 GS Adventure (K51) 2019-2020**



1.50kg 4 mm AI Aluminum

ENGINE GUARD

SKU: 2CP0900050****



4.68kg 25 mm AI Aluminum

CRASHBARS

SKU: 2CP1970071****

Available in various colors
See page: 191

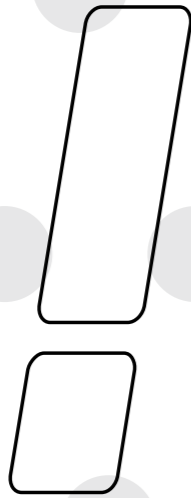

***CrossPro,
Ride it
like a PRO...***



@sergiorosario_photographer

for the real ADVENTURERS

NEW



360°



* Compatible with OEM and CrossPro Skid Plate but not compatible with CrossPro CrashBars

Available in various colors
See page: 191

DUCATI DesertX 2022

.....more special parts in next page

for the real ADVENTURERS

NEW



360°

DUCATI DesertX 2022

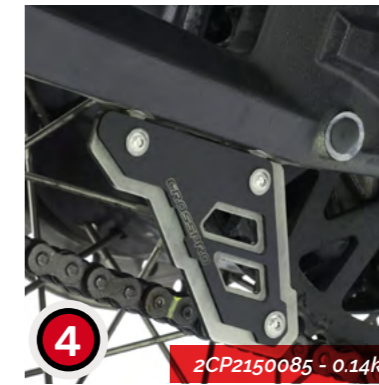
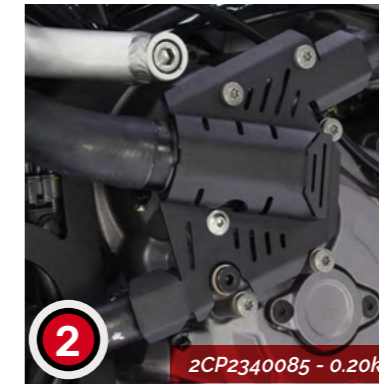

Available in various colors
See page: 191

■ HONDA CB500X 2013-2018



CRASHBARS

SKU: 2CP1250026****

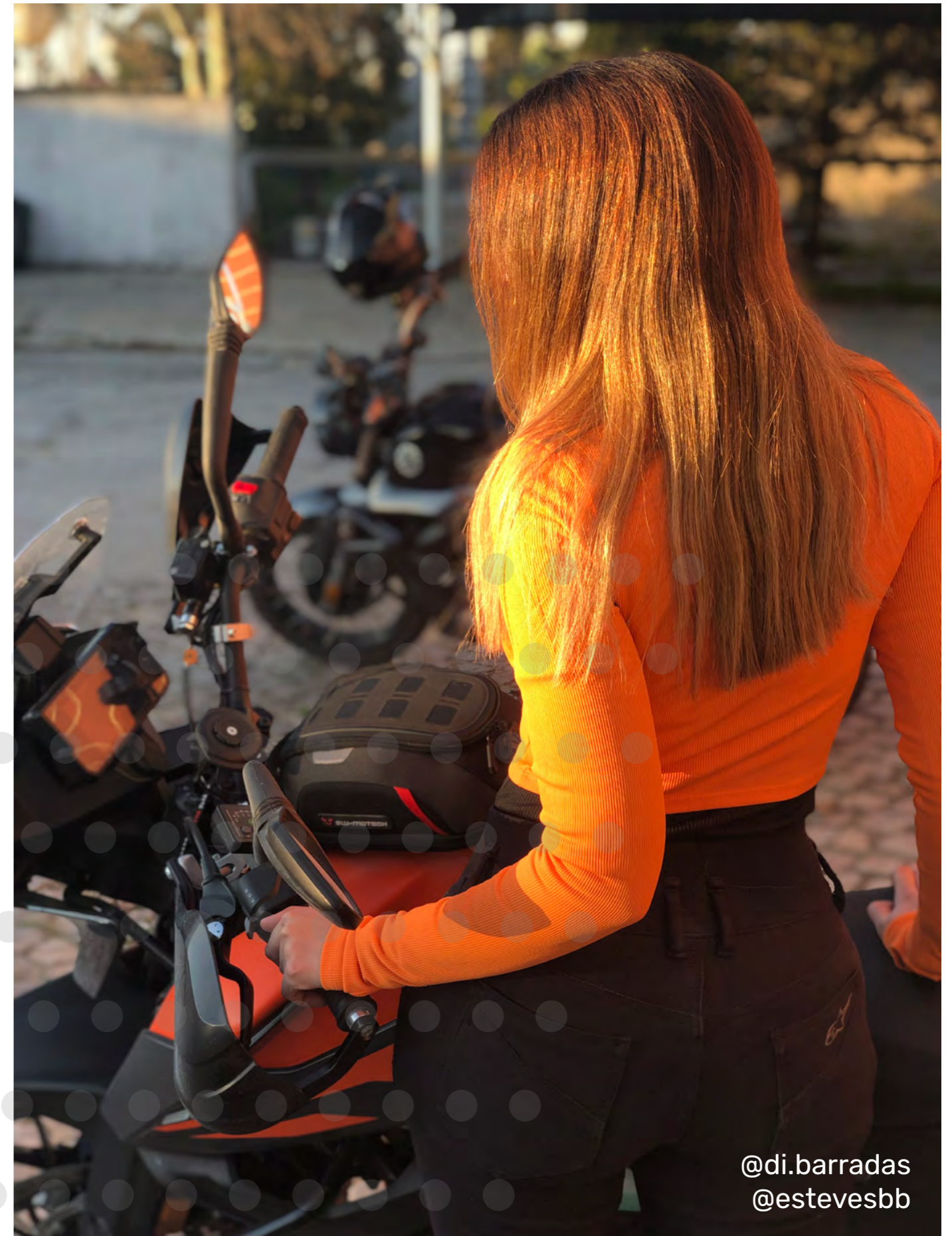

@di.barradas
@estevesbb



■ HONDA CB 500 X 2019-2022



ENGINE GUARD

SKU: 2CP0900057****



RADIATOR GUARD

SKU: 2CP2270057****



CRASHBARS

SKU: 2CP1970057****

for the real **ADVENTURERS**



■ HONDA CB 650 R 2019-2021



RADIATOR GUARD

SKU: 2CP2270074****



**Not for dual clutch*

■ HONDA NC 700 X 2012-2017

NC 750 X 2014-2015



ENGINE GUARD

SKU: 2CP0900058****



CRASHBARS

SKU: 2CP1250011****



@GRDuarte



↻ 360°



HONDA NC 750 X 2016-2020

**Not for dual clutch*



3.08kg 4mm AI Aluminum

ENGINE GUARD

SKU: 2CP0900058****



2.10kg 25mm AI Aluminum

CRASHBARS

SKU: 2CP1970058****

Available in various colors
See page: 191

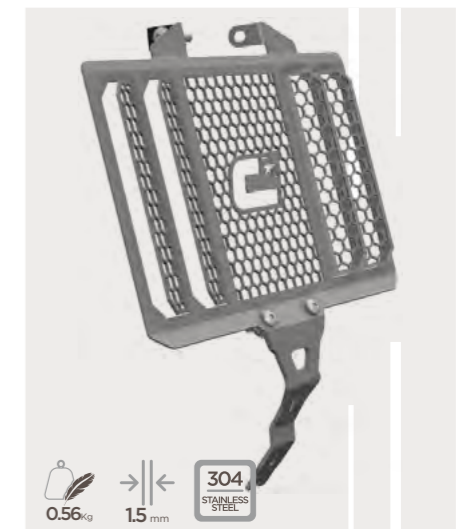

0.56kg 1.5mm 304 STAINLESS STEEL

RADIATOR GUARD

SKU: 2CP2270058****

for the real **ADVENTURERS**



ENGINE GUARD

SKU: 2CP0900073****



CRASHBARS

SKU: 2CP1970073****



RADIATOR GUARD

SKU: 2CP2270058****



■ HONDA NC 750X 2021

**Not for dual clutch*



for the real **ADVENTURERS**

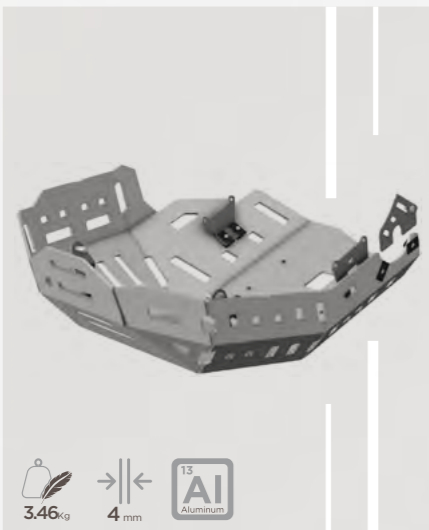

3.46kg 4mm 15 AI Aluminum

ENGINE GUARD

SKU: 2CP0900076****



214kg 25mm 15 AI Aluminum

CRASHBARS

SKU: 2CP1970073****



0.56kg 1.5mm 304 STAINLESS STEEL

RADIATOR GUARD

SKU: 2CP2270058****



■ HONDA NC 750 X

DCT 2021

Available in various colors
See page: 191

for the real **ADVENTURERS**



■ HONDA XRV750 Africa Twin 1993-2000

 Available in
various colors

See page: 191



 2.80kg  22 mm  13 AI Aluminum

CRASHBARS

SKU: 2CP1250027****





■ HONDA X-ADV 750 2017-2022

 Available in various colors

See page: 191



 2.20kg  4mm  13 AI Aluminum

ENGINE GUARD

SKU: 2CP090052A**** //PART NUMBER UPDATED



 2.11kg  25mm  13 AI Aluminum

CRASHBARS

SKU: 2017-2020 2CP1970052****
SKU: 2021-2022 2CP1970086****

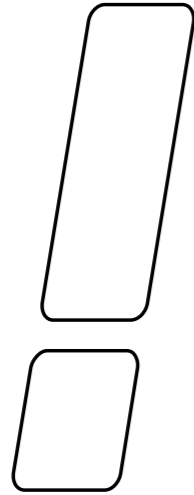

***CrossPro,
design
&
build...***



@GRDuarte

for the real **ADVENTURERS**



@enduro.world.tr

■ HONDA CRF1000Africa Twin & Adventure Sport 2016-2019



ENGINE GUARD

SKU: 2CP090023A****



CRASHBARS

SKU: *Normal Clutch 2CP197023A****

SKU: *Dual Clutch 2CP197024A****



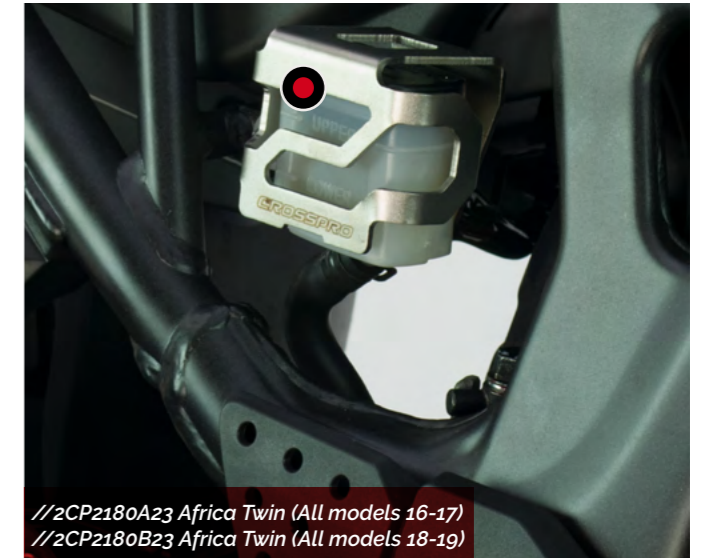
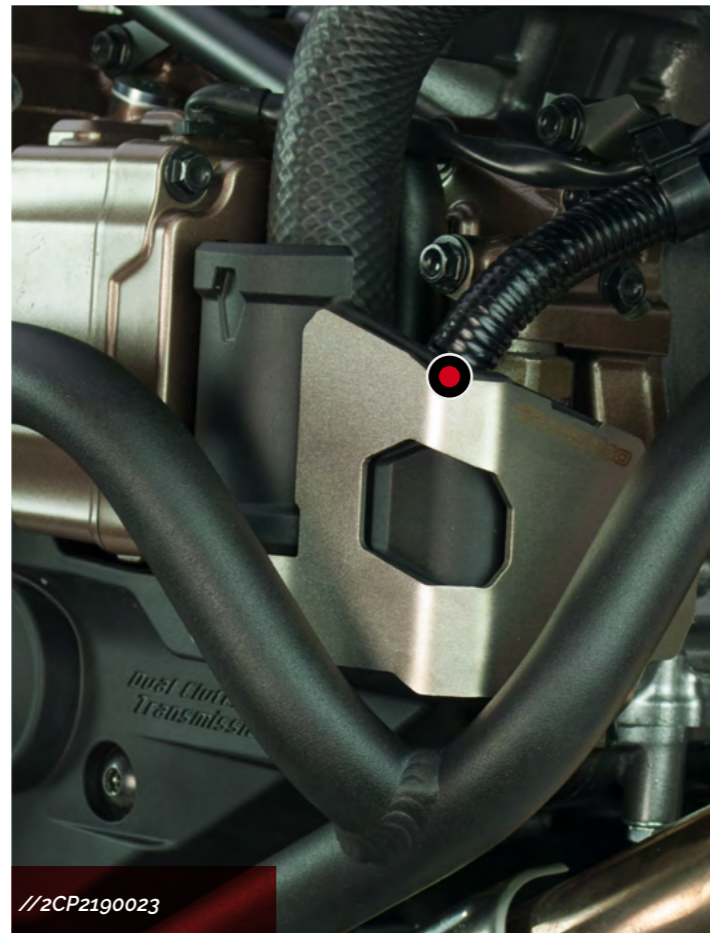

for the real **ADVENTURERS**



■ HONDA CRF 1100L Africa Twin 2020-2022



2.94g 4 mm AI Aluminum

ENGINE GUARD

SKU: 2CP090061A****

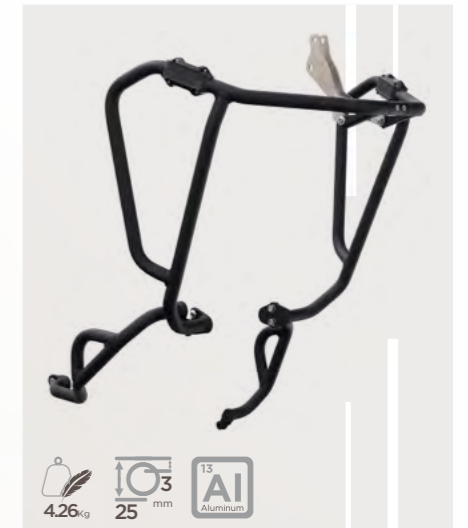

4.26g 25 mm AI Aluminum

CRASHBARS

-Adventure Sport
SKU: **DCT** 2CP1970063****
SKU: **Normal Clutch** 2CP197059A****

-Normal Model
SKU: **DCT** 2CP1970066****
SKU: **Normal Clutch** 2CP1970061****

 Available in various colors
See page: 191

for the real **ADVENTURERS**

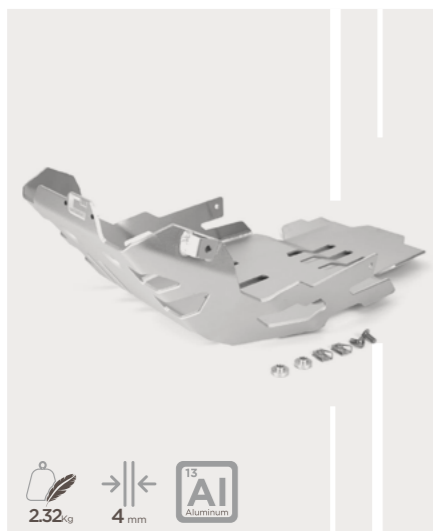
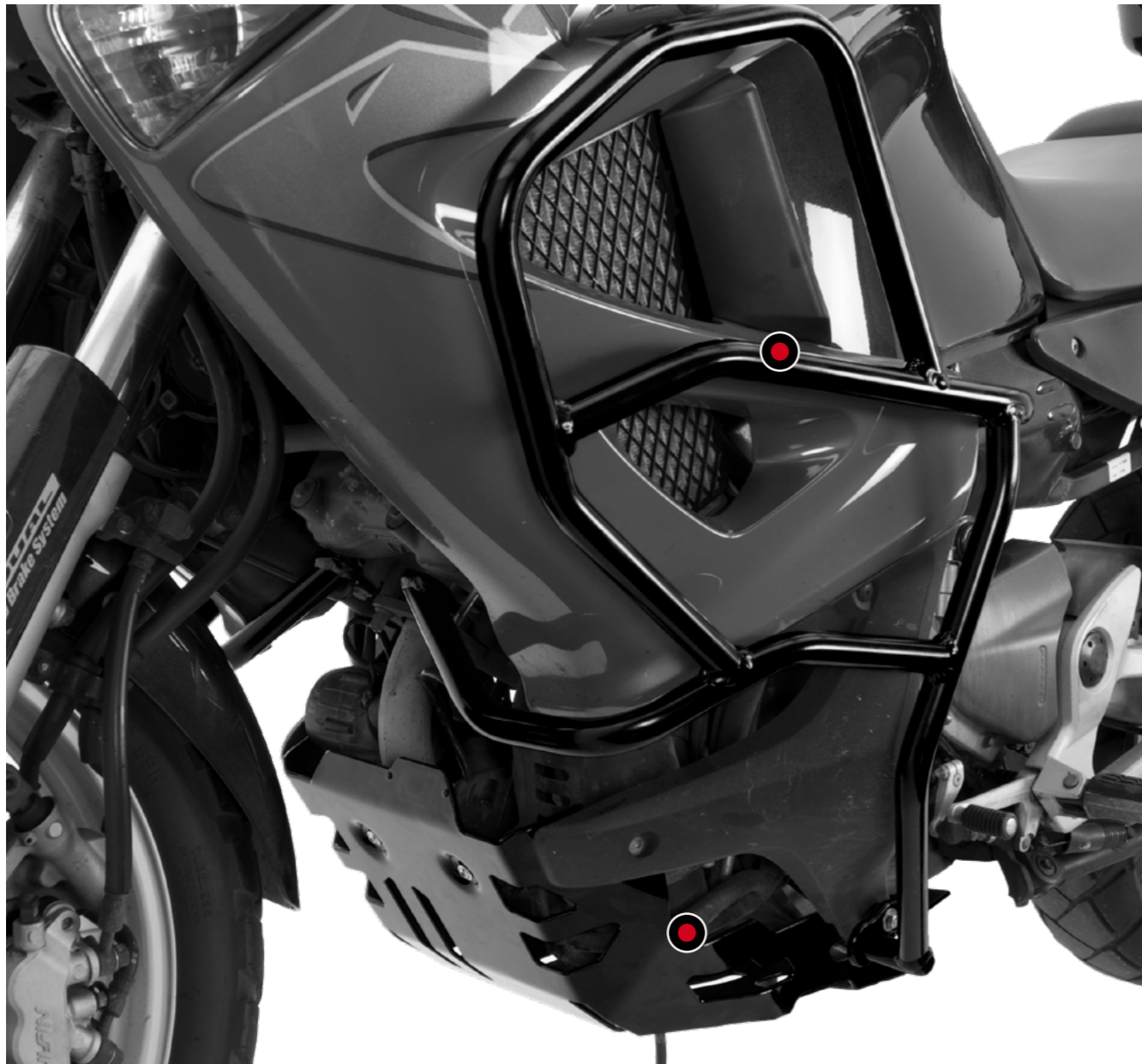

2.32g 4 mm 

ENGINE GUARD

SKU: *2007-2011 2CP090004A****



3.20g 22 mm 

CRASHBARS

SKU: *1999-2011 2CP125004A****

 Available in various colors

See page: 191

■ HONDA XL 1000 VARADERO 1999-2011



for the real ADVENTURERS

■ HONDA VFR 1200 X CROSS TOURER 2012-2015



2.66kg 4mm AI Aluminum

ENGINE GUARD

SKU: 2CP090009A****



1.72kg 22mm AI Aluminum

CRASHBARS

SKU: 2CP1250009****



Available in various colors
See page: 191



@di.barradas
@estevesbb

for the real ADVENTURERS

NEW



↻ 360°

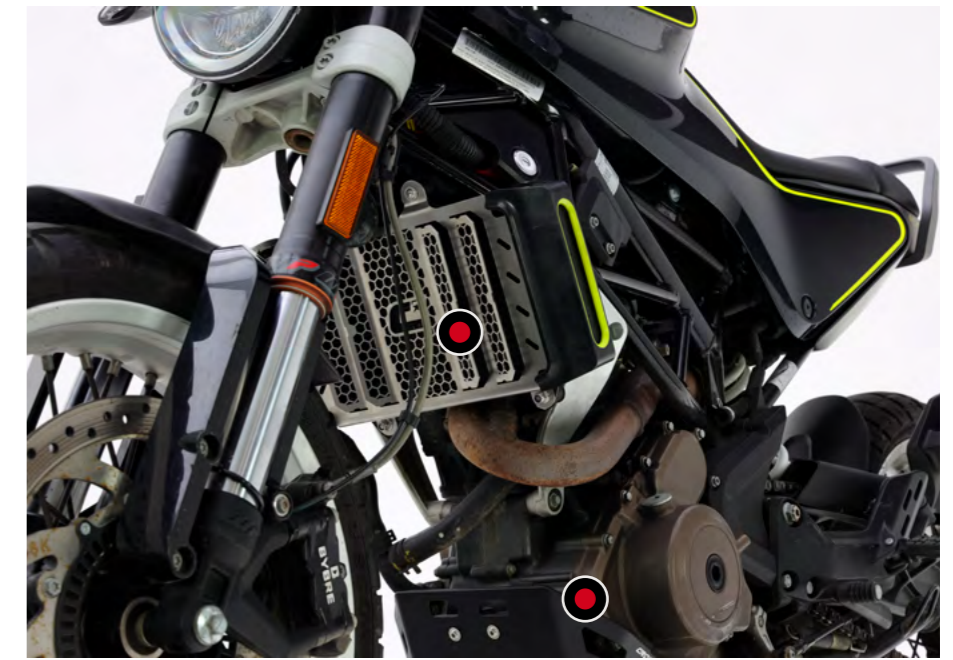

ENGINE GUARD

SKU: 2CP0900081****

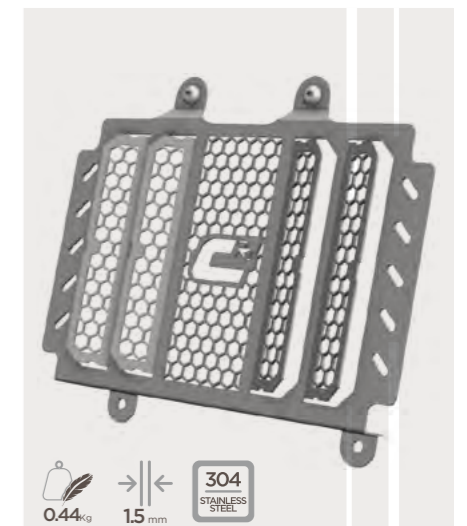

CRASHBARS

SKU: 2CP2270081****

HUSQVARNA SVARTPILEN 401 VITPILEN 401 2018-2019

Available in various colors
See page: 191

for the real ADVENTURERS

NEW

HUSQVARNA NORDEN 901 2022

Available in various colors
See page: 191



360°



2.60g 4 mm AI Aluminum

ENGINE GUARD

SKU: 2CP090051A****



2.06g 25 mm AI Aluminum

CRASHBARS UPPER

SKU: 2CP197UP78****



0.18g 2 mm 304 STAINLESS STEEL

SIDE STAND EXTENTION

SKU: 2CP2200078****

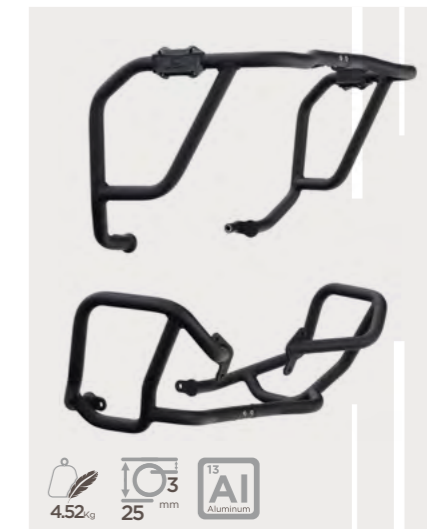

4.52g 25 mm AI Aluminum

CRASHBARS COMPLETE

SKU: 2CP1970078****



2.46g 25 mm AI Aluminum

CRASHBARS LOWER

SKU: 2CP197LW78****



0.22g 2 mm 304 STAINLESS STEEL

EXHAUST MANIFOLD PROTECTION

SKU: 2CP0900A51****
*Compatible with OEM Skid Plate

**■ KAWASAKI
KLE 650
VERSYS
2007/10-2014**



ENGINE GUARD

SKU: * 2007-2014 2CP0900008****



CRASHBARS

SKU: * 2010-2014 2CP1250008****



Available in various colors
See page: 191



■ **KAWASAKI**
KLE 650
VERSYS 2015-2021

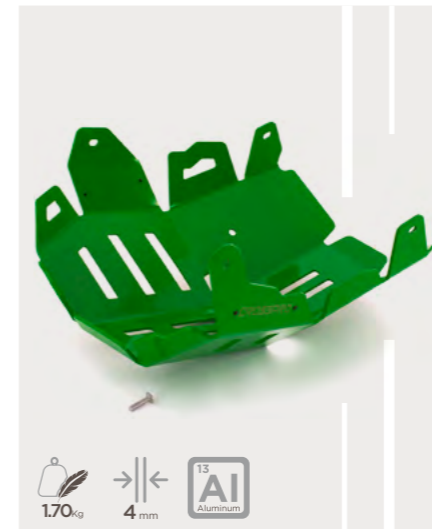

ENGINE GUARD

SKU: 2CP0900039****



CRASHBARS

SKU: 2CP1970039****



■ KAWASAKI KLR 650 2008-2015

Available in various colors
See page: 191



1.38 kg 4 mm AI Aluminum

ENGINE GUARD

SKU: 2CP0900014****

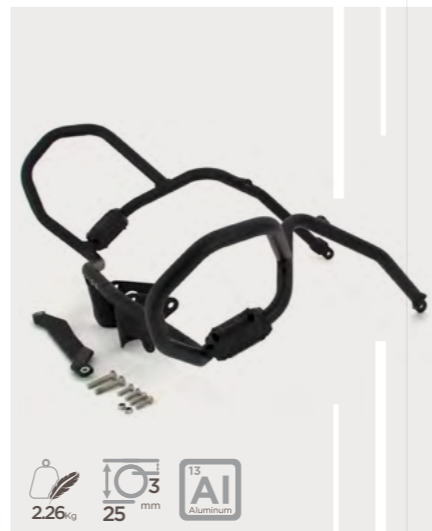

2.26 kg 25 mm AI Aluminum

CRASHBARS

SKU: 2CPI250014****

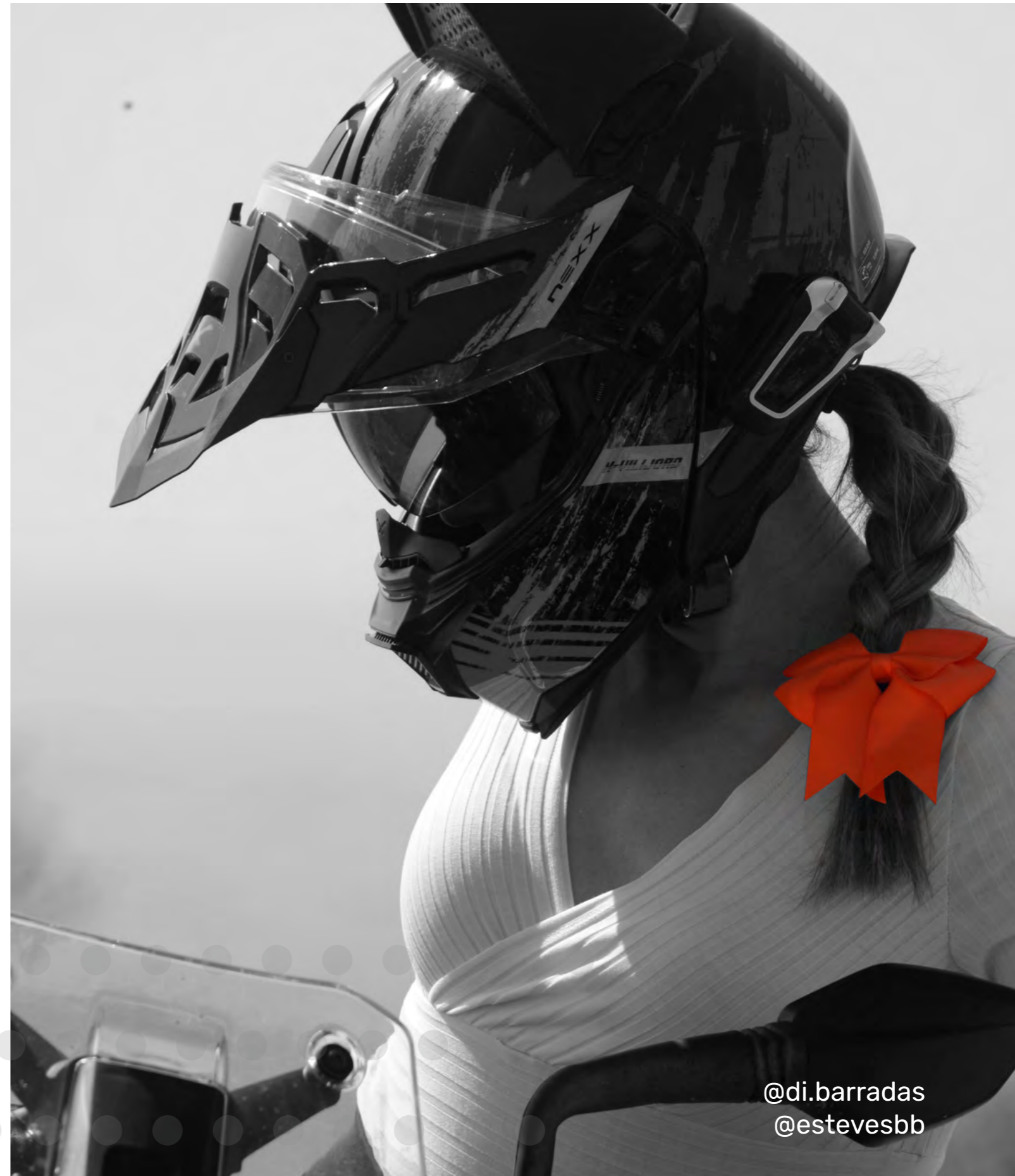

@di.barradas
@estebesbb



1.30kg
4 mm
Aluminum

ENGINE GUARD

SKU: 2CP0900018****

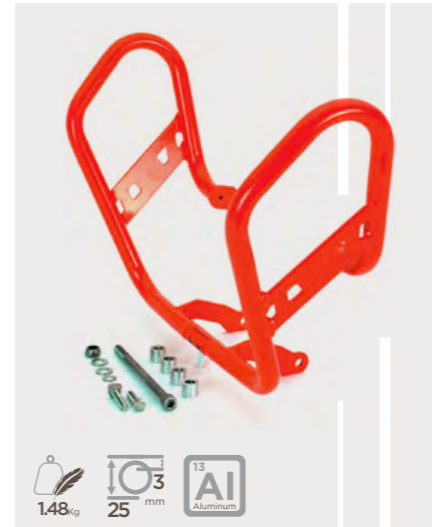

1.48kg
25 mm
Aluminum

CRASHBARS

SKU: 2CP1250018****

Available in various colors
See page: 191

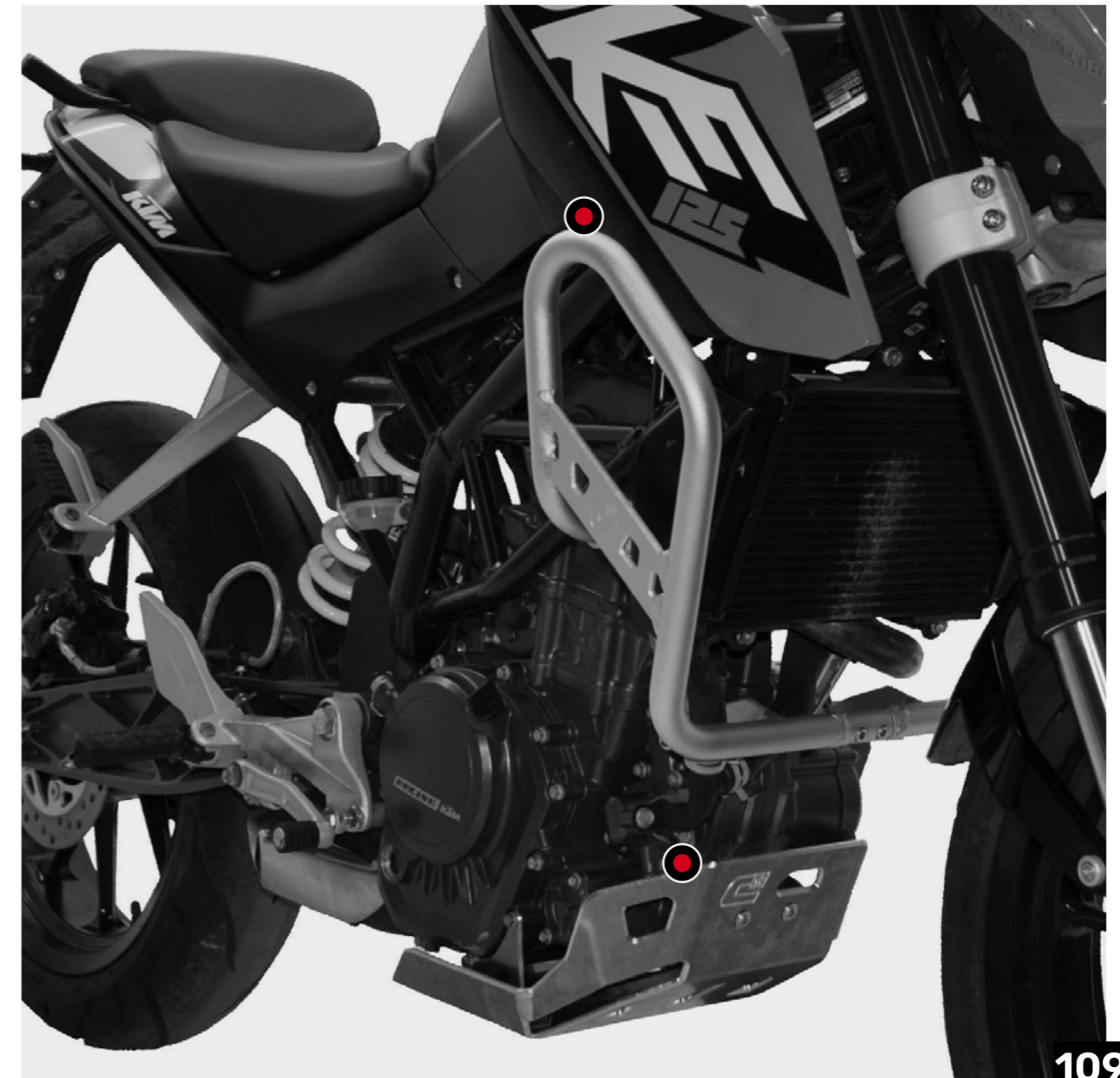

■ **KTM** **DUKE 125 2011-2016** **&** **DUKE 200 2012-2017**

■ KTM

DUKE 250 2015-2016

DUKE 390 2013-2017

Available in various colors
See page: 191



1.40kg 4mm AI Aluminum

ENGINE GUARD

SKU: 2CP0900021****



1.46kg 22mm AI Aluminum

CRASHBARS

SKU: 2CP1250021****

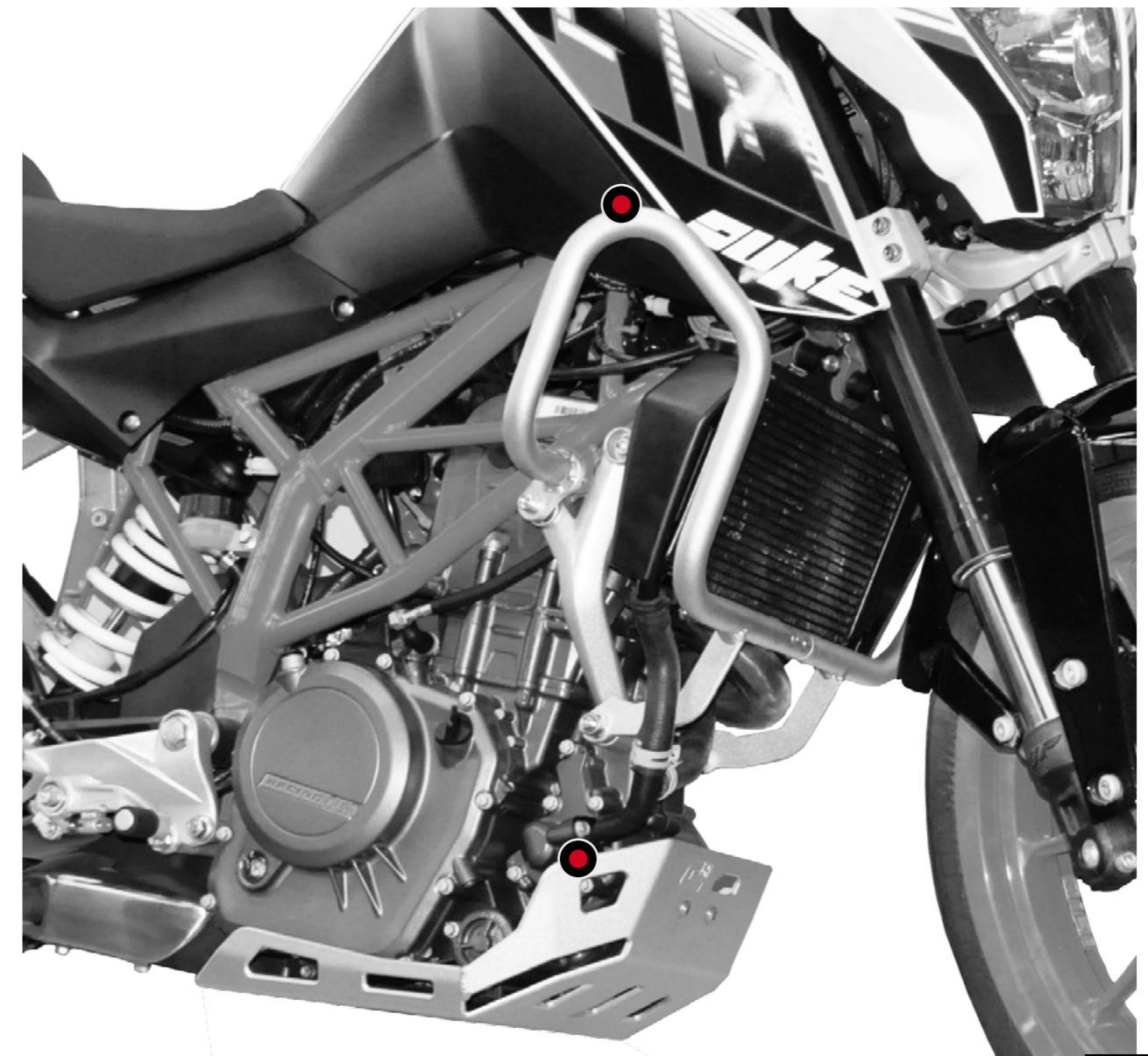

for the real **ADVENTURERS**



ENGINE GUARD

SKU: 2CP0900068****



CRASHBARS

SKU: 2CP197068A**** //PART NUMBER UPDATED



SIDE STAND EXTENTION

SKU: 2CP2200068****



■ KTM ADVENTURE 250/390 2020-2022



for the real **ADVENTURERS**



3.86kg
25 mm
13 AI
Aluminum

CRASHBARS

SKU: 2CP197051A****



2.60kg
4 mm
13 AI
Aluminum

ENGINE GUARD

SKU: 2CP090051A****



0.22kg
2 mm
304
STAINLESS
STEEL

EXHAUST MANIFOLD PROTECTION

SKU: 2CP0900A51****
** Compatible with OEM Skid Plate*

■ KTM 790 Adventure 2019-2021

Available in
various colors

See page: 191



■ KTM 890Adventure 2021

 Available in various colors

See page: 191



 3.86g
 25 mm
 13 AI Aluminum

CRASHBARS

SKU: 2CP197051A**** //PART NUMBER UPDATED



 2.60g
 4 mm
 13 AI Aluminum

ENGINE GUARD

SKU: 2CP090051A****



 0.22g
 2 mm
 304 STAINLESS STEEL

EXHAUST MANIFOLD PROTECTION

SKU: 2CP0900A51****
** Compatible with OEM Skid Plate*



@claudiamsss

@di.barradas

for the real **ADVENTURERS**



ENGINE GUARD

SKU: 2CP0900013****



CRASHBARS

SKU: 2CP1250013****

■ **KTM**

Adventure

950 2002-2006

990 2006-2012

 Available in various colors

See page: 191



■ KTM LC8 990 SM-T 2011-2013



3.08 kg 4 mm AI Aluminum

ENGINE GUARD

SKU: 2CP0900016****



2.40 kg 22 mm AI Aluminum

CRASHBARS

SKU: 2CP1250016****

 Available in various colors

See page: 191



for the real **ADVENTURERS**



@sergiorosario_photographer



ENGINE GUARD

SKU: 2CP090022A****

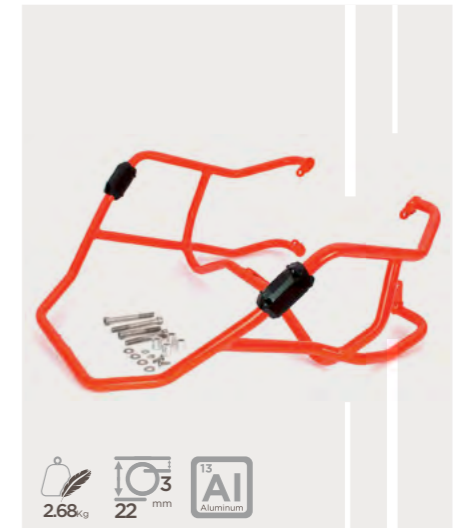

CRASHBARS

SKU: 2CP1250022****

■ KTM 1190 Adventure 2013-2016

Available in various colors
See page: 191



■ KTM 1290 Super Adventure 2015-2019



2.22g 4 mm AI Aluminum

ENGINE GUARD

SKU: 2CP090022A****

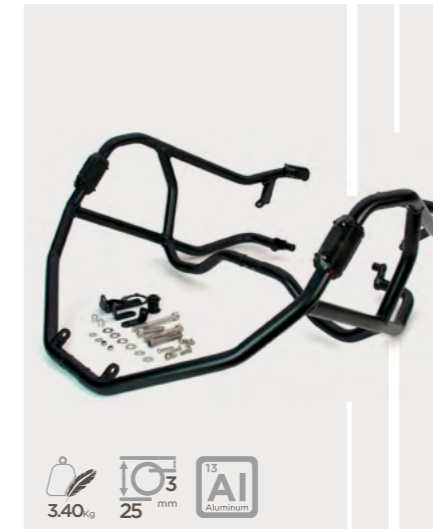

3.40g 25 mm AI Aluminum

CRASHBARS

SKU: *2017-2019 2CP197034A****

///PART NUMBER UPDATED

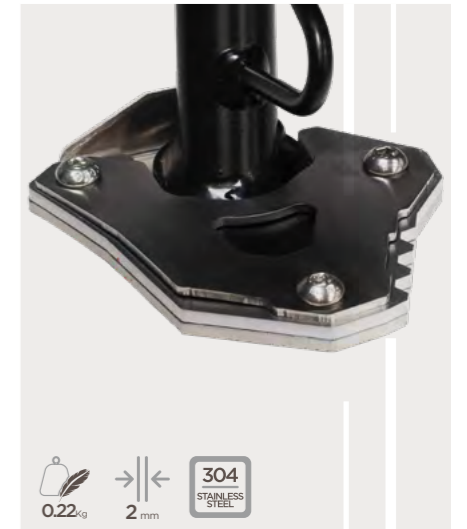

0.22g 2 mm 304 STAINLESS STEEL

SIDE STAND EXTENSION

SKU: 2CP2200068****

Available in various colors
See page: 191



for the real **ADVENTURERS**



2.22kg 4mm AI Aluminum

ENGINE GUARD

SKU: 2CP090022A****



3.40kg 25mm AI Aluminum

CRASHBARS

SKU: 2CP197034A****



0.22kg 2mm 304 STAINLESS STEEL

SIDE STAND EXTENTION

SKU: 2CP2200068****

■ KTM 1290 Super Adventure 2020



Available in various colors

See page: 191





■ KTM 1290 Super Adventure 2021-2022

Available in various colors
See page: 191



3.78kg 4mm AI Aluminum

ENGINE GUARD

SKU: 2CP0900075****



4.66kg 25mm AI Aluminum

CRASHBARS

SKU: 2CP197075A**** // PART NUMBER UPDATED



0.64kg 1.5mm 304 STAINLESS STEEL

RADIATOR GUARD

SKU: 2CP2270075****



0.22kg 2mm 304 STAINLESS STEEL

SIDE STAND EXTENTION

SKU: * S Models 2CP2200075****

SKU: * R Models 2CP2200078****

// MODELS UPDATED

for the real ADVENTURERS

NEW

MOTO-MORINI X-CAPE 649 2022



2CP1970083 - 3.40kg



2CP0900083 - 3.00kg



2CP2180087 - 0.04kg



2CP2270083 - 0.60kg



360°



2CP2200083 - 0.18kg



Available in various colors
See page: 191





@GRDuarte

***CrossPro,
Ride it
like a PRO...***



CRASHBARS

SKU: 2CP1250032****

■ SUZUKI DL250 V-STROM 2018-2020

Available in
various colors

See page: 191

■ SUZUKI DL 650 V-STROM 2008-2011



ENGINE GUARD

SKU: 2CP0900002****

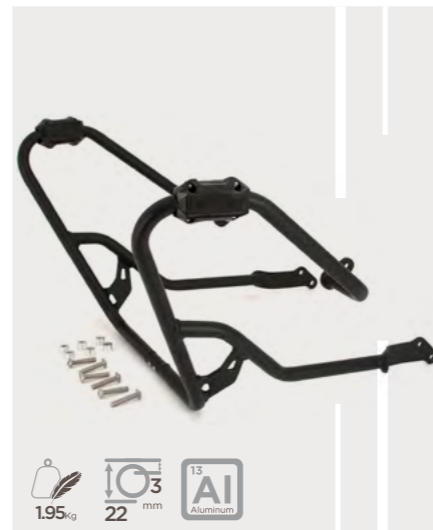

CRASHBARS

SKU: 2CP1250002****



for the real **ADVENTURERS**



ENGINE GUARD

SKU: 2CP0900012****

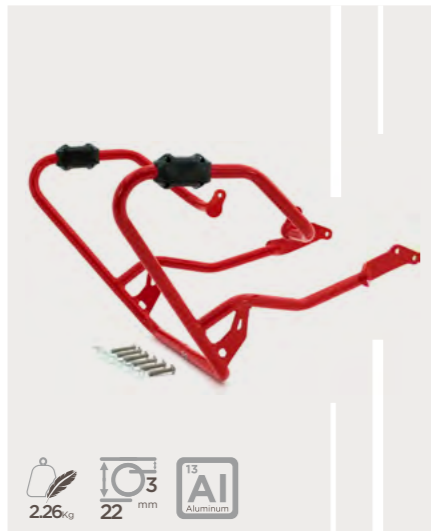

CRASHBARS

SKU: 2CP1250012****



■ **SUZUKI**
DL 650
V-STROM
2012-2016

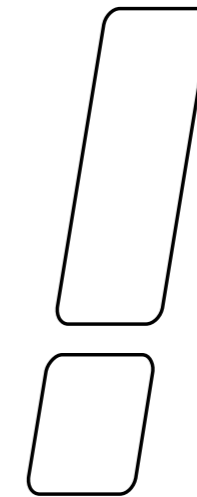

***CrossPro, The
Parts That
Power
Your Life***

■ SUZUKI DL 650 V-STROM 2017-2022



250g 4 mm AI Aluminum

ENGINE GUARD

SKU: 2CP0900029****



3.42g 25 mm AI Aluminum

CRASHBARS

SKU: 2CP1970029****



■ SUZUKI DL 1000 V-STROM 2002-2013



ENGINE GUARD

SKU: 2CP0900006****



CRASHBARS

SKU: 2CP1250006****

Available in various colors

See page: 191





■ SUZUKI DL 1000 V-STROM 2014-2016



1.82 kg 4 mm 15 AI Aluminum

ENGINE GUARD

SKU: 2CP0900017****



2.90 kg 22 mm 15 AI Aluminum

CRASHBARS

SKU: 2CP1250017****



for the real **ADVENTURERS**



ENGINE GUARD

SKU: 2CP090028A****



CRASHBARS

SKU: 2CP1970028****



■ SUZUKI DL1000 V-STROM 2017-2019



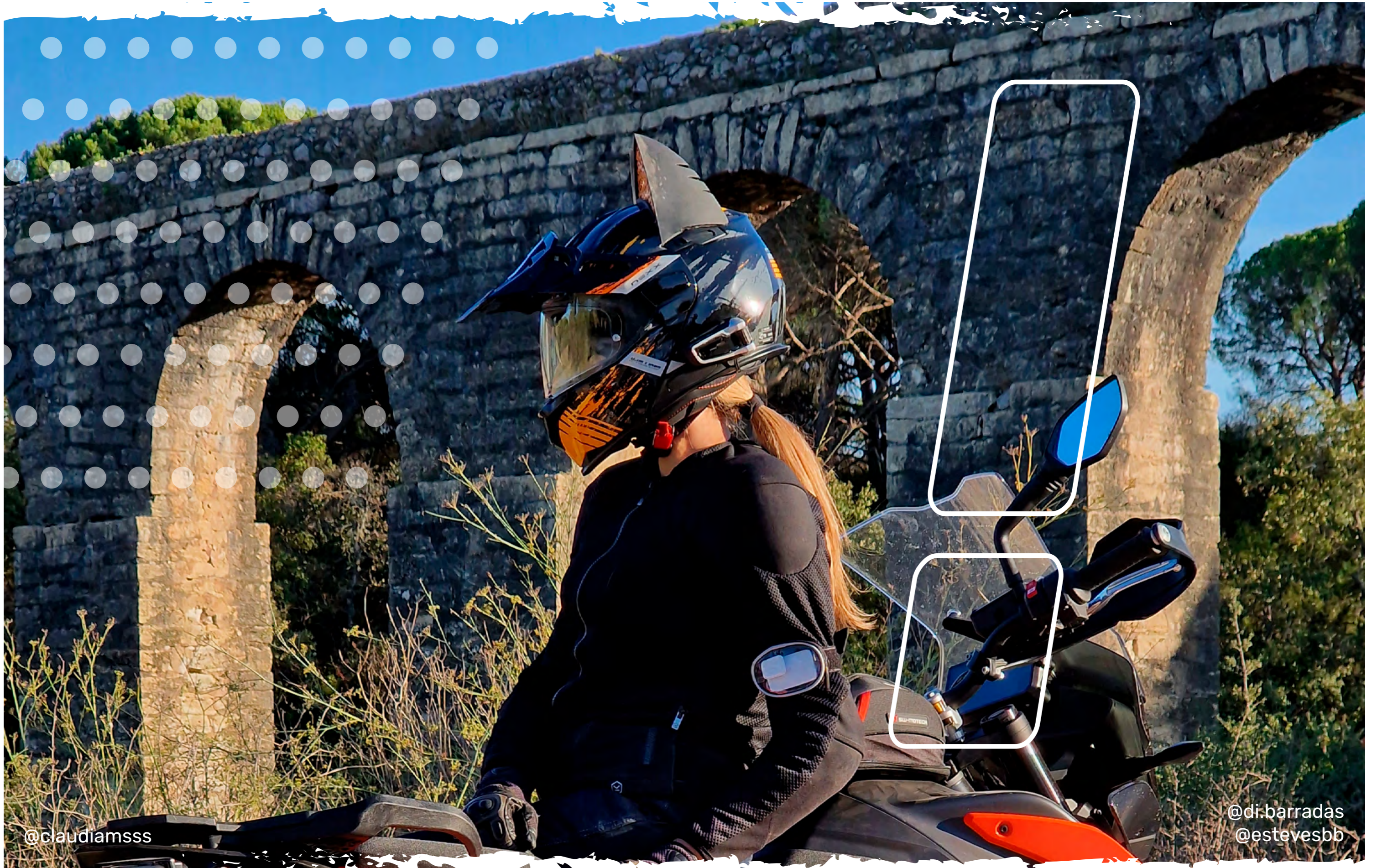



2.92g 4mm AI Aluminum

ENGINE GUARD

SKU: 2CP0900065****



3.04g 25mm AI Aluminum

CRASHBARS

SKU: 2CP1970065****
**Incompatible with OEM CrashBars*



0.54g 1.5mm 304 STAINLESS STEEL

RADIATOR GUARD

SKU: 2CP2270065****



360°



0.80g 2.0mm 304 STAINLESS STEEL AI Aluminum

CHAIN GUARD

SKU: 2CP2140065****



0.22g 2.0mm 304 STAINLESS STEEL

BRAKE CALLIPER GUARD

SKU: 2CP2170065****

■ SUZUKI DL1050 V-STROM 2020-2022

Available in various colors
See page: 191

for the real **ADVENTURERS**

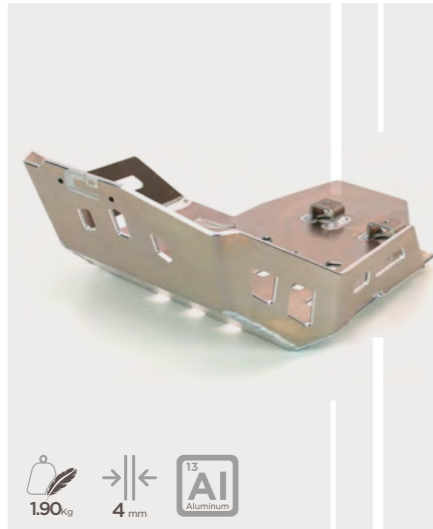

1.90g 4 mm 15 AI Aluminum

ENGINE GUARD

SKU: 2CP090020A****

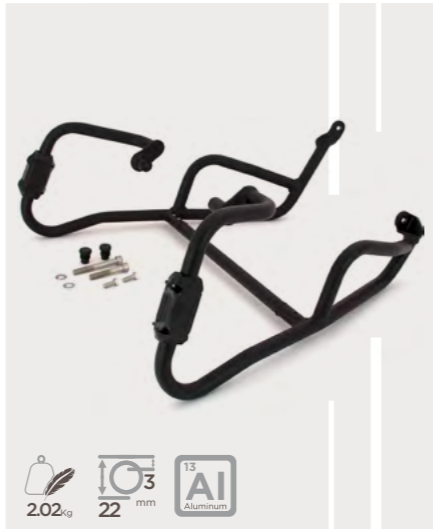

2.02g 22 mm 15 AI Aluminum

CRASHBARS

SKU: 2CPI250020**** Only 2011-2014

Available in various colors
See page: 191

■ TRIUMPH TIGER 800 XC/XCX/XR 2011-2016

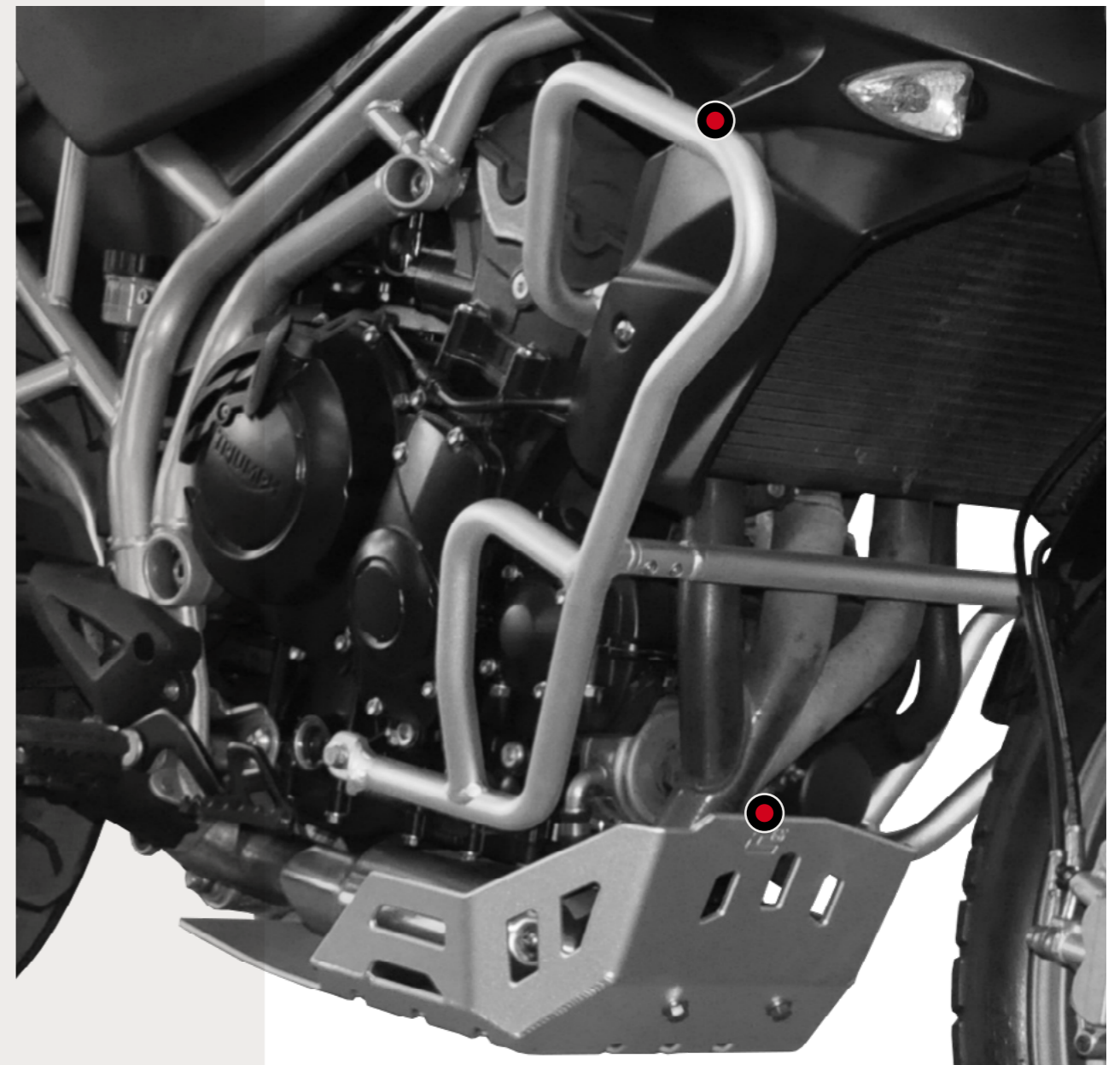

for the real ADVENTURERS

NEW

Available in various colors
See page: 191

TRIUMPH TIGER 900

GT / GTLOW / GTPRO / RALLY / RALLYPRO

2021-2022

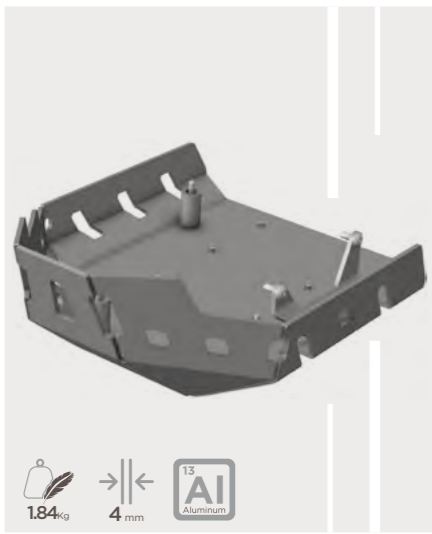

ENGINE GUARD

SKU: 2CP0900079****

* Compatible with OEM Crash Bars

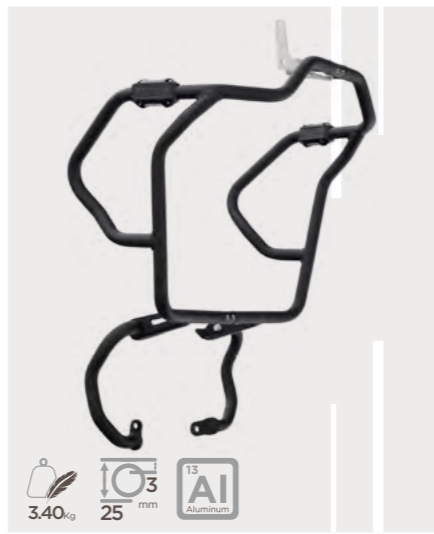

CRASHBARS

SKU: 2CP1970079****

* Not Compatible With OEM Auxiliary Headlights



SIDE STAND EXTENSION

SKU: 2CP2200079****

* Only for side stand part no. 2086415

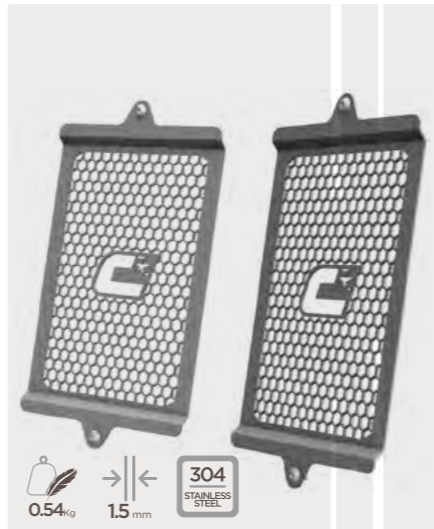

RADIATOR GUARD

SKU: 2CP2270079****



360°

for the real **ADVENTURERS**



Available in various colors
See page: 191

■ TRIUMPH TIGER 1200 XC 2018-2019



188g 4 mm AI Aluminum

ENGINE GUARD

SKU: 2CP0900048****

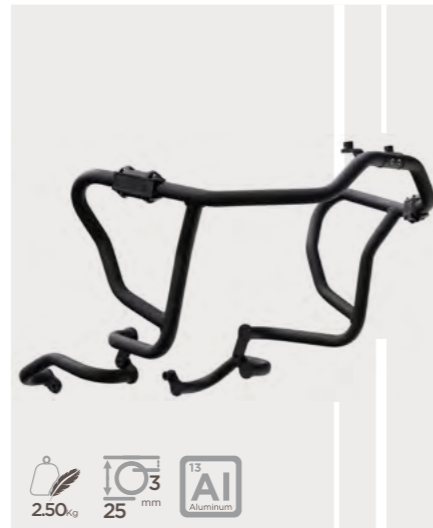

250g 25 mm AI Aluminum

CRASHBARS

SKU: 2CP1970048****

for the real **ADVENTURERS**

■ YAMAHA MT-07 2018-2020



1.08kg
25 mm
AI
Aluminum

CRASHBARS

SKU: 2CP1970064****



0.64kg
1.5 mm
304
STAINLESS
STEEL

RADIATOR GUARD

SKU: 2CP2270064****

Available in
various colors
See page: 191

for the real ADVENTURERS



↻ 360°



CRASHBARS

SKU: 2CP1970067****



YAMAHA TRACER 700 2020-2021

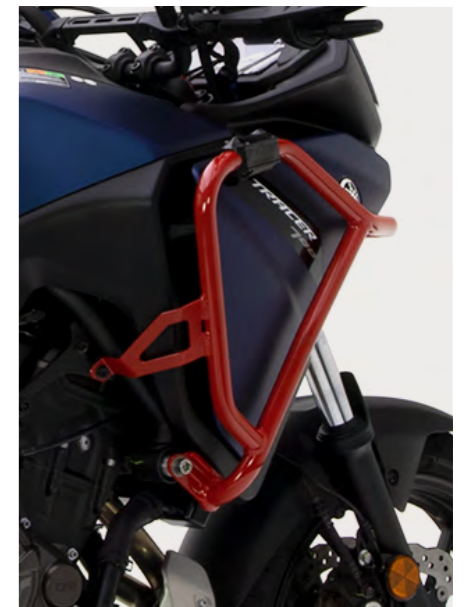
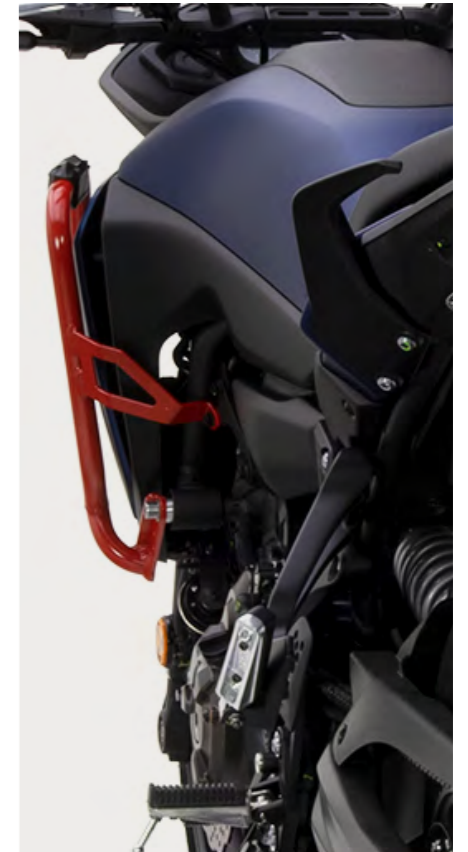



CrossPro, The Parts That
Power Your **Life**

@StromOnTour



CRASHBARS

SKU: 2CP1250025****



■ YAMAHA MT-09 TRACER 900 2015-2017





■ YAMAHA TRACER 900 / 900 GT 2018-2020



CRASHBARS

SKU: 2CP1970070****



RADIATOR GUARD

SKU: 2CP2270070****

 Available in
various colors

See page: 191

for the real **ADVENTURERS**



■ YAMAHA TRACER 900/900GT 2021-2022



2.78kg 4mm 15 AI Aluminum

ENGINE GUARD

SKU: 2CP0900077****

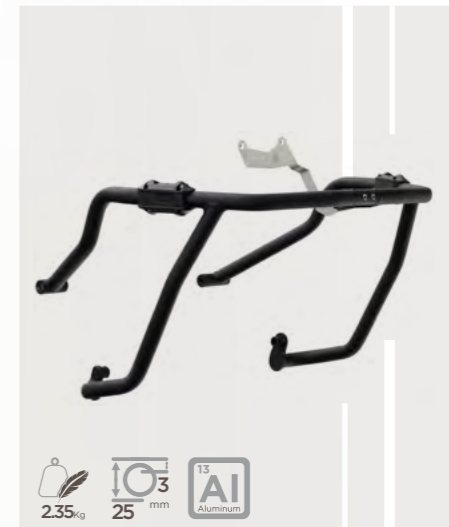

2.35kg 25mm 15 AI Aluminum

CRASHBARS

SKU: 2CP1970077****



0.18kg 2mm 304 STAINLESS STEEL

SIDE STAND EXTENSION

SKU: 2CP2200077****



0.56kg 1.5mm 304 STAINLESS STEEL

RADIATOR GUARD

SKU: 2CP2270077****

■ YAMAHA XTZ 660 TÉNÉRÉ 2008-2015



ENGINE GUARD

SKU: 2CP0900007****



CRASHBARS

SKU: 2CP1250007****



See page: 191





@claudiamsss

@di.barradas
@estevesbb

■ YAMAHA XTZ 700 TÉNÉRÉ & Rally Edition 2020-2022

Available in
various colors
See page: 191



360°



2.70 kg 25 mm 15 AI Aluminum

CRASHBARS

SKU: 2CP197055A****



2.50 kg 4 mm 15 AI Aluminum

ENGINE GUARD

SKU: • EURO 4 2CP0900055****

SKU: • EURO 5 2CP090072A****

/// EURO 5 MODEL PART NUMBER UPDATED

for the real ADVENTURERS

NEW

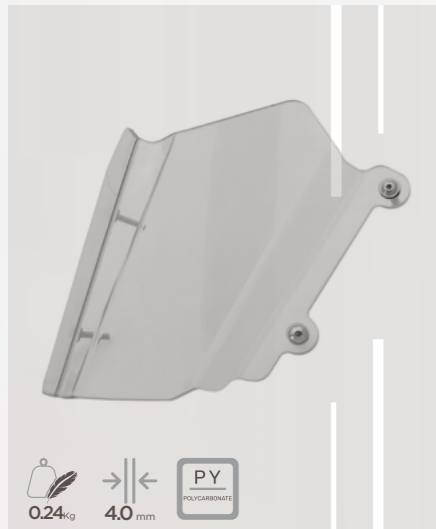

0.24kg 4.0mm PY POLYCARBONATE

HEAD LIGHT PROTECTOR

SKU: 2CP2210082****



2.44kg 4mm AI ALUMINUM

ENGINE GUARD

SKU: 2CP090072A****



3.66kg 25mm AI ALUMINUM

CRASHBARS

SKU: 2CP1970082****
** Compatible with OEM Skid Plate*

YAMAHA XTZ700TÉNÉRÉ WORLD RAID 2022



360°

Available in various colors
See page: 191



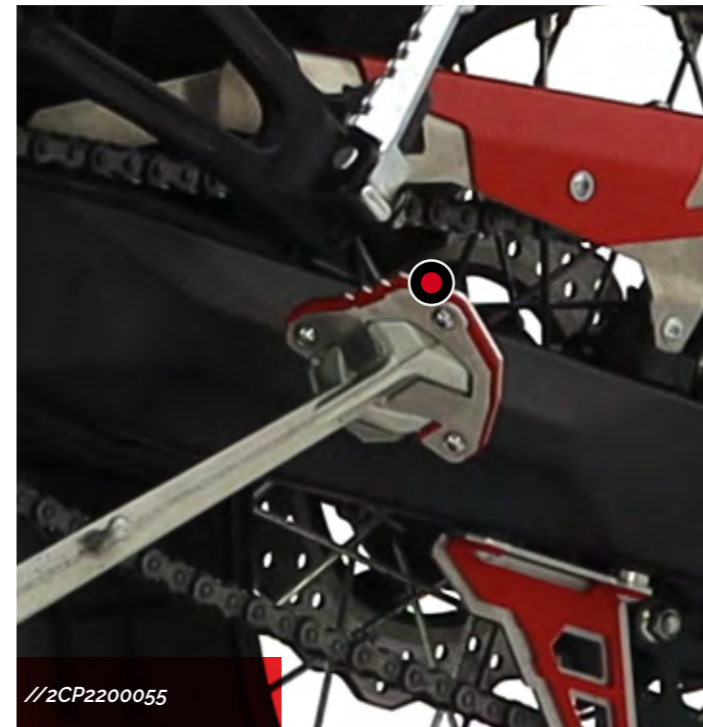
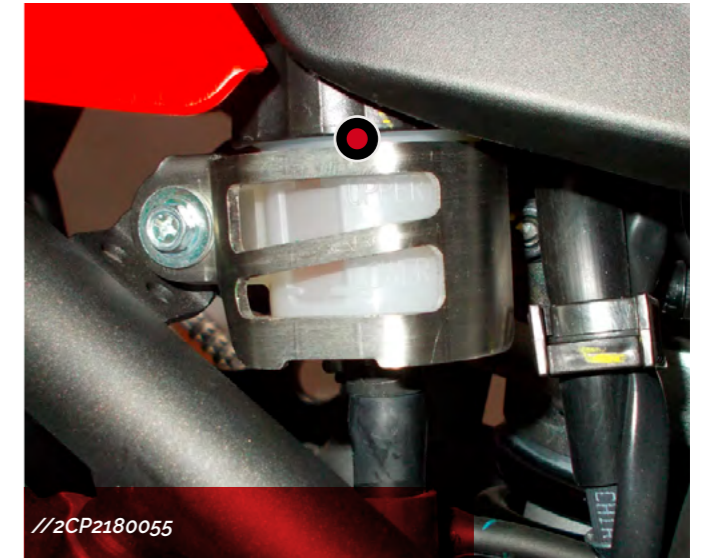
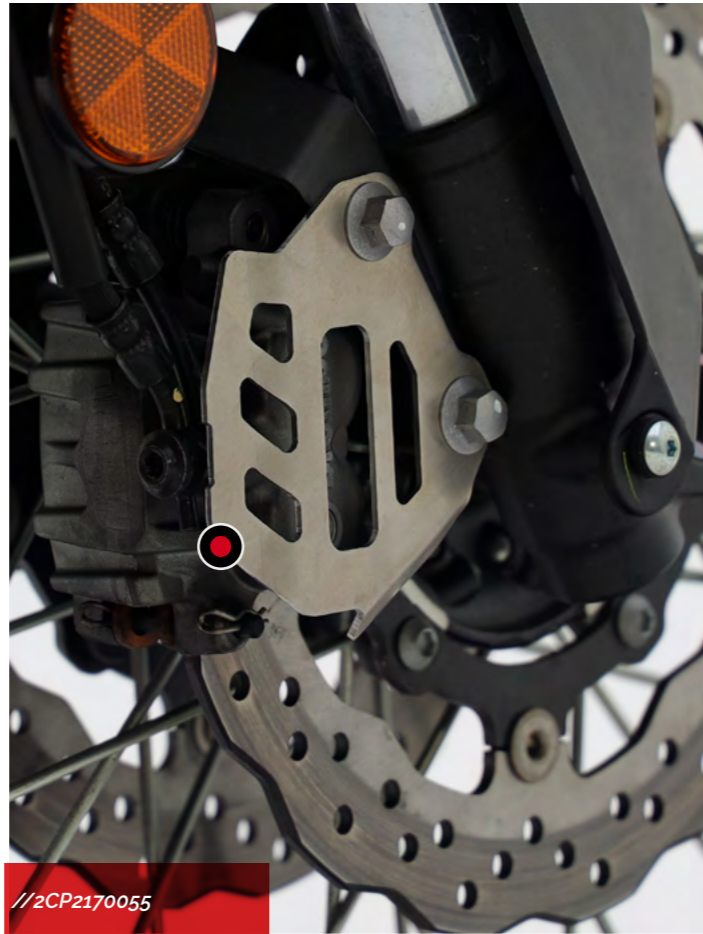



@enduro.world.tr

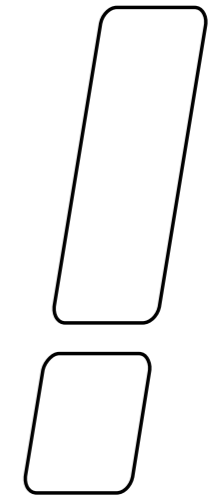

***CrossPro,
Countless
parts.
Happy
hearts.***

■ YAMAHA XTZ 700 TÉNÉRÉ 2020-2021 (EURO 4 ONLY)



↻ 360°



DTC Engine Guard (NOT compatible with EURO 5)

- Trail DTC Skidplate.
- Tested in hostile conditions, these skidplates offer the best protection for the engine and frame of your bike in hard tracks.
- Produced in best quality DTC with 8mm thickness without holds, they're 40% lighter comparing with aluminum. They're more resistant to impact and cause no vibrations.
- Reinforced with 6mm stripes below to overcome easily obstacles.
- Available in different colors (Blue, Red and Black).

//2CP1240050300 - Black Color
//2CP1240050400 - Blue Color
//2CP1240050500 - Red Color

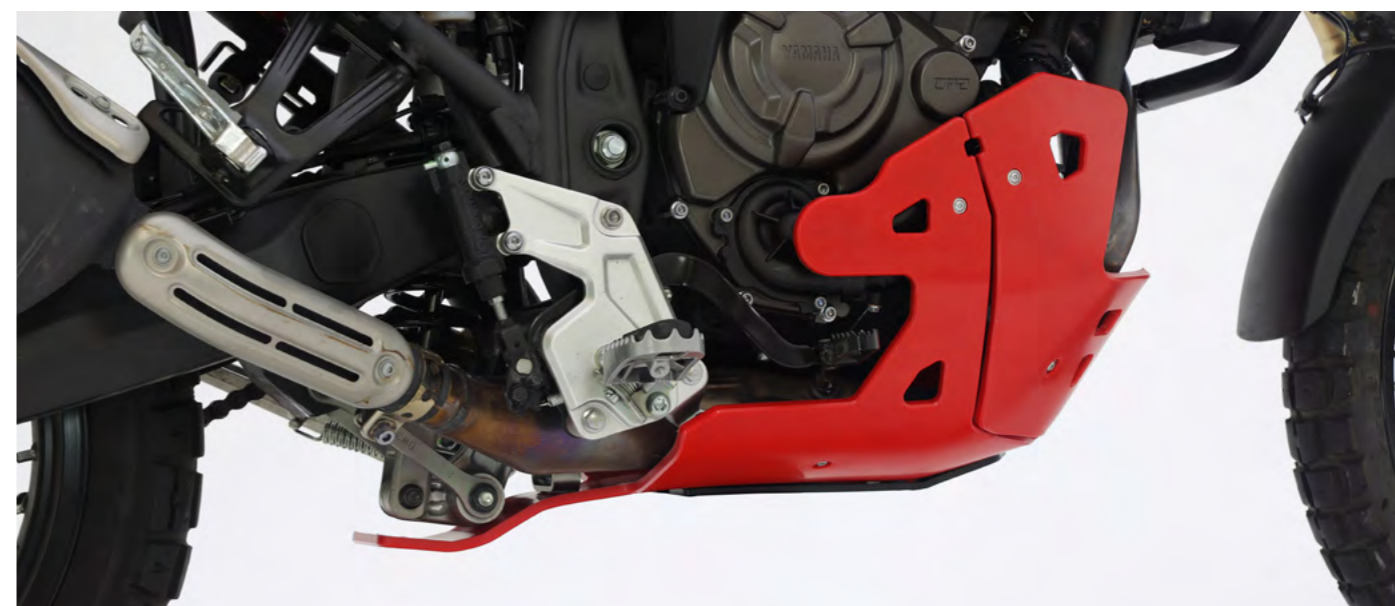
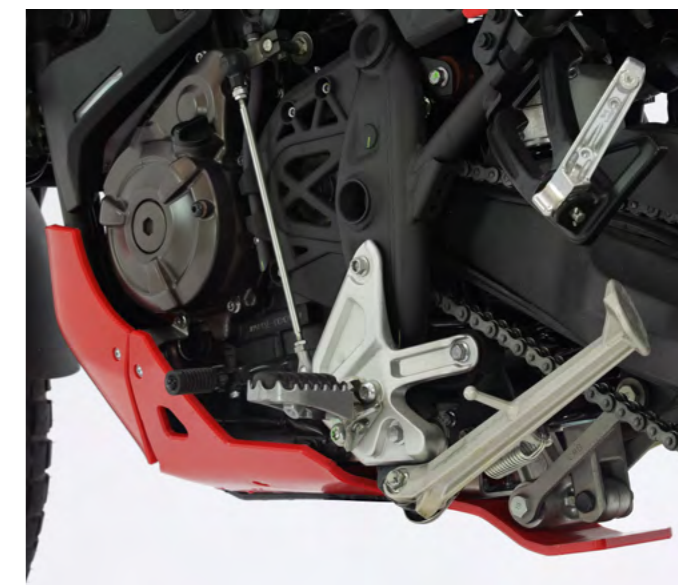



2.60kg
4mm
AI
Aluminum

ENGINE GUARD

SKU: 2CP0900019****

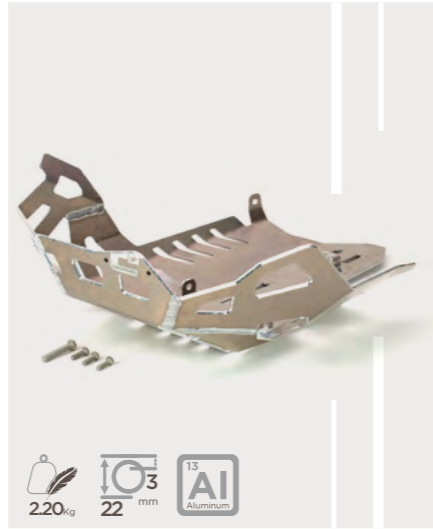

2.20kg
22mm
AI
Aluminum

CRASHBARS

SKU: 2CP1250019****



■ **YAMAHA
XTZ 1200
SUPER TÉNÉRÉ
2010-2014**



@StromOnTour

CROSSPRO AROUND THE WORLD

A CROSSPRO prima pela excelência e rigor na procura e desenvolvimento de novas soluções, com produtos inovadores de alta qualidade que vão ao encontro da exigência dos nossos clientes e da procura do mercado.

Antevendo sempre todas as exigências, a CROSSPRO ao longo da sua existência aumentou a sua gama de produtos e atualmente está presente em mais de 40 países .

A internacionalização foi sem dúvida um passo decisivo para exponenciar as vendas representando cerca de 95% da produção atual.

Made by CROSSPRO

CROSSPRO stands out for excellence and rigor in the research and development of new solutions, with innovative high quality products that meet the demands of our customers and the market itself.

Always anticipating all requirements, CROSSPRO during its existence has increased its range of products and is currently present in more than 40 countries all over the world.

Internationalization was undoubtedly a decisive step to increase sales, representing around 95% of current production.

Made by CROSSPRO

Europe

Áustria
Belgium
Cyprus
Czech Republic
Denmark
Finland
France
Germany
Greece
Holland
Hungary
Italy
Latvia
Lithuania
Norway
Poland
Portugal
Romania
Slovakia
Slovenia
Spain
Sweden
Switzerland
United Kingdom

Asia

Dubai
Iran
Israel
Japan
Kwait
Malaysia
Philippines
Russia
Singapore
Thailand
Turkey

AMERICA

Argentina
Canada
Chile
USA
Mexico

OCEANIA

Australia
New Zealand

AFRICA

South Africa
Morocco



■ ELECTROSTATIC PAINT PROCESS

 *Indicative weights*
Pesos indicativos



“Painting is done through lacquering, which is an electrostatic painting process performed with powder paints.”



We have 9 different colors for your guards!

-  Black
ral: 9005
-  Textured Black
ral: 9005 text
-  White
ral: 9110
-  Red
ral: 3020
-  Green
ral: 6018
-  Blue
ral: 5002
-  Yellow
ral: 1021
-  Orange
ral: 2004
-  Ice Polish Protected varnish color

A pintura é realizada por lacagem, que consiste num processo de pintura eletrostático executado com tintas em pó.

The painting is carried out by the lacquering method, which consists of an electrostatic painting process performed with powder paints.

Este processo, bem como o tratamento a que as peças são sujeitas, reforça a proteção anticorrosiva e maximiza a adesão e duração da tinta.

This process, together with a final treatment technique applied to the pieces, reinforces the anti-corrosion protection and maximizes the adhesion and duration of the paint.

No nosso processo de lacagem dispomos de 9 cores diferentes para as suas proteções.

With this lacquering process we have 9 different colors for the protections.

Um processo simples, eficaz e resistente.

A simple, effective and resistant process.



Zona Industrial do Paraimo, Lote 45
3780-524 - Sangalhos | Anadia | Portugal

Gps: 40°28'31.0"N 8°28'39.5"W

Phone: +351 234 629 044
www.crosspro.pt
E-mail: geral@crosspro.pt

2CPCATDS23



Management
System
ISO 9001:2015



www.tuv.com
ID 910507726